

Greg Delaney (Clinical Assistant Professor at UB)
Haley Hartmans (Sutton Development)
Robert Stark (Principal at CJS Architects)
Rachel Adams (Associate Curator of UB Art Galleries)
Joe Ebert (Designer and Cultural Critic)

INTERMISSION

Michael Tunkey (Principal at Cannon Design)
Sara Witschi (Development Manager at Ciminelli Real Estate)
LaLuce Mitchell (Architect and Preservationist at Flynn Battaglia Architects)
Jenifer Kaminsky (PUSH Buffalo)
Michael Hungerford (FoundFuture)



BUFFALO

ARCHITECTURE
FOUNDATION

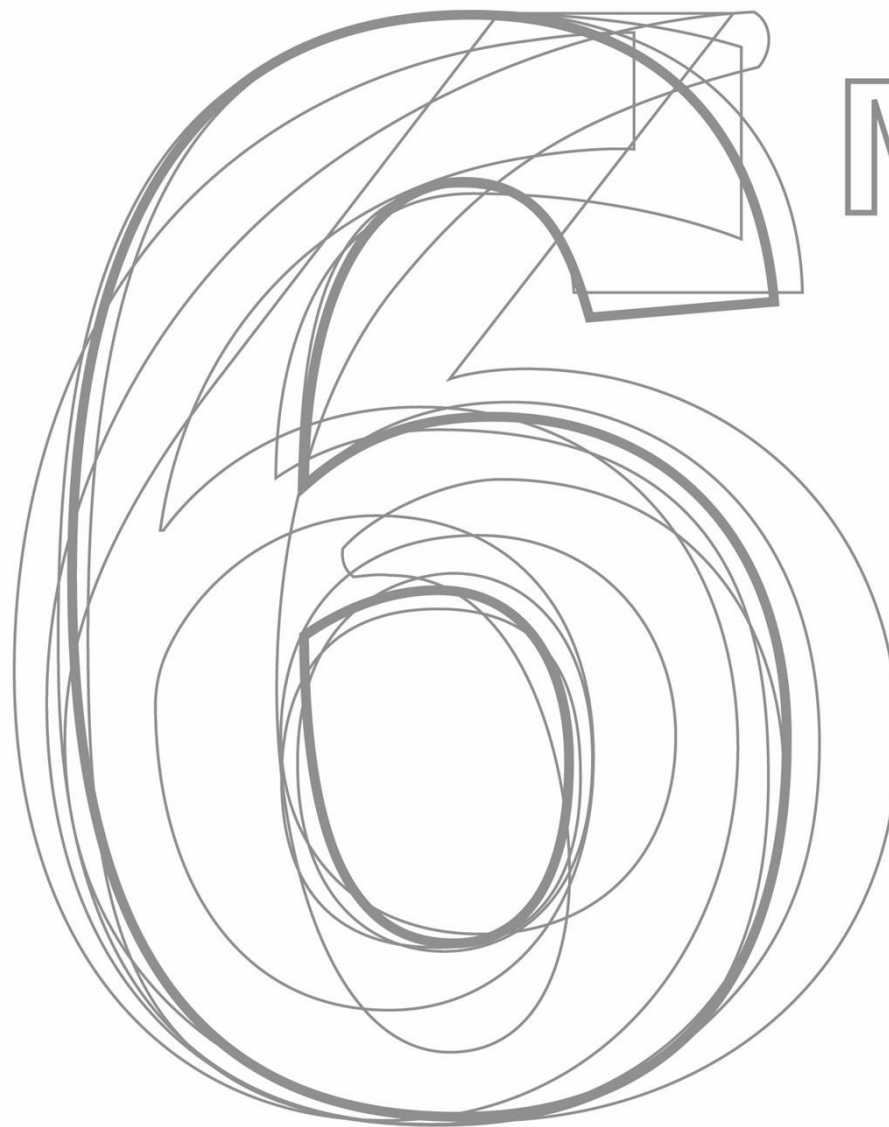

Mbs



See the Building Stories digital collection at

UB LIBRARIES

University at Buffalo *The State University of New York*













AIA BUFFALO/WNY





Greg Delaney

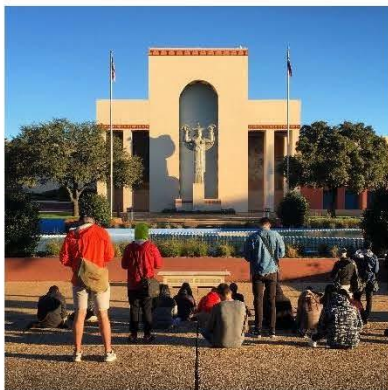

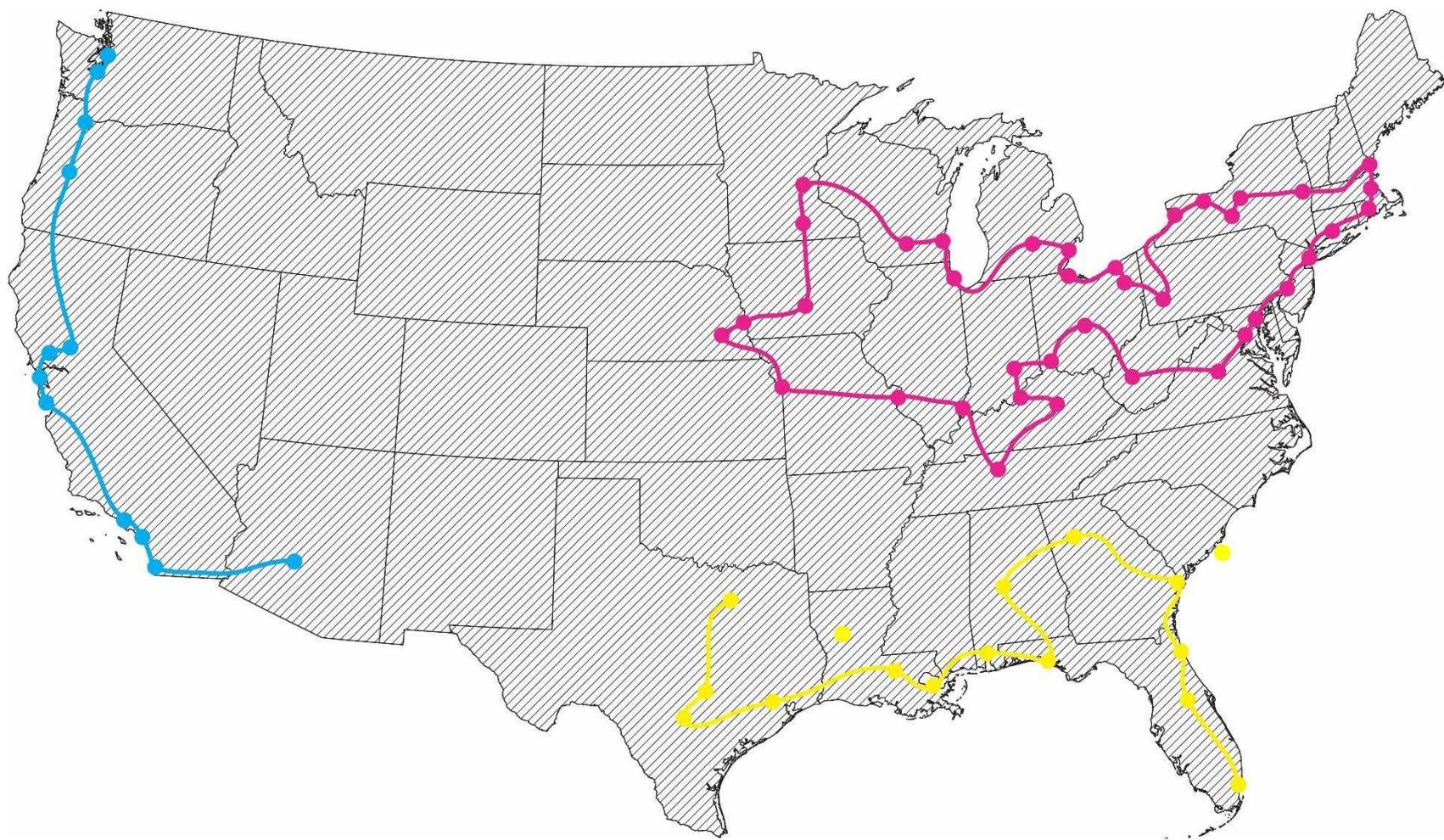





CHICAGO STANDARD QUARTER SECTION

As Used for Computations

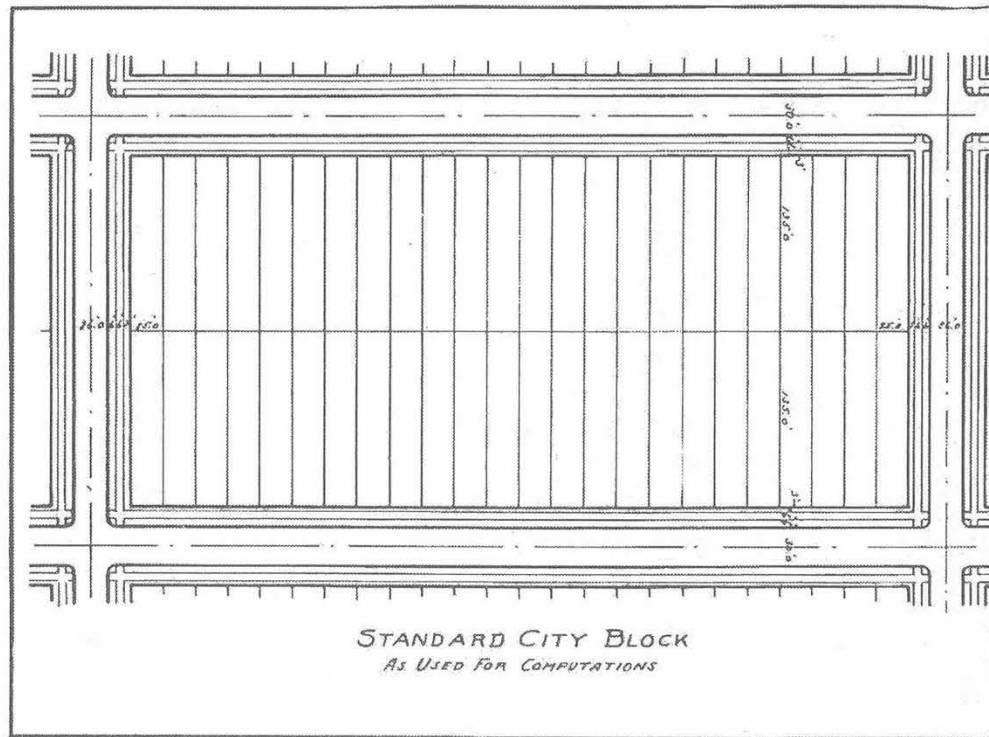
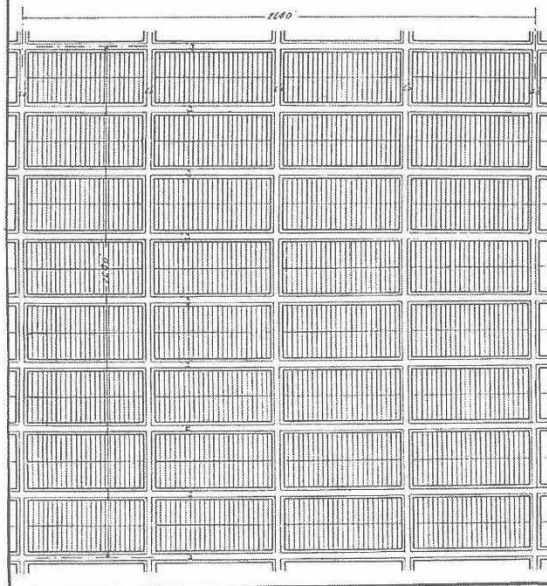

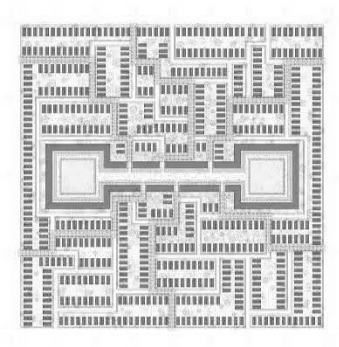
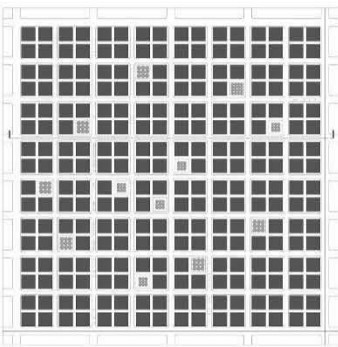
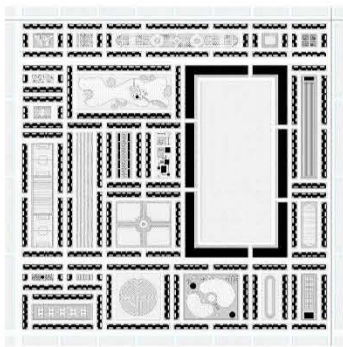
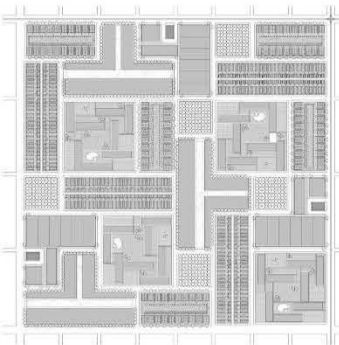
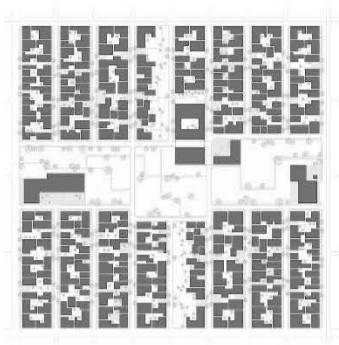
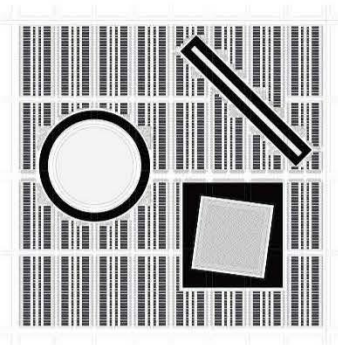
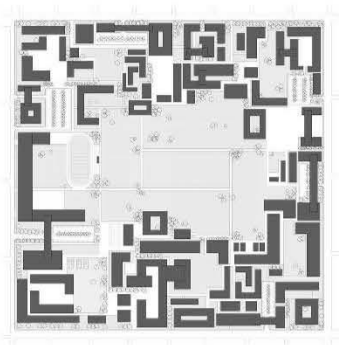
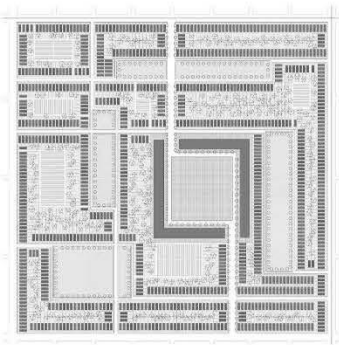
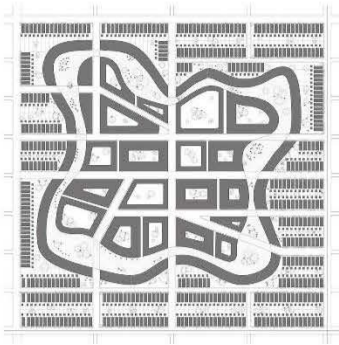
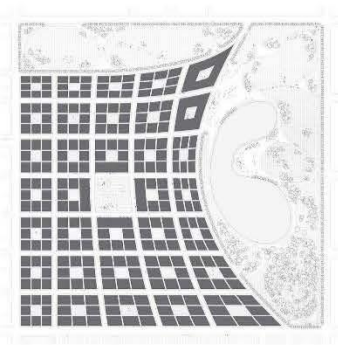
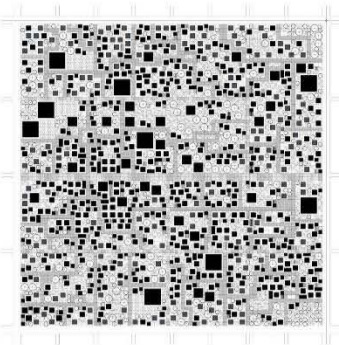
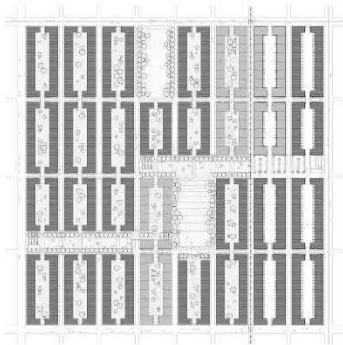

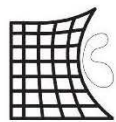

SEWING THREAD

Asuka Fujita

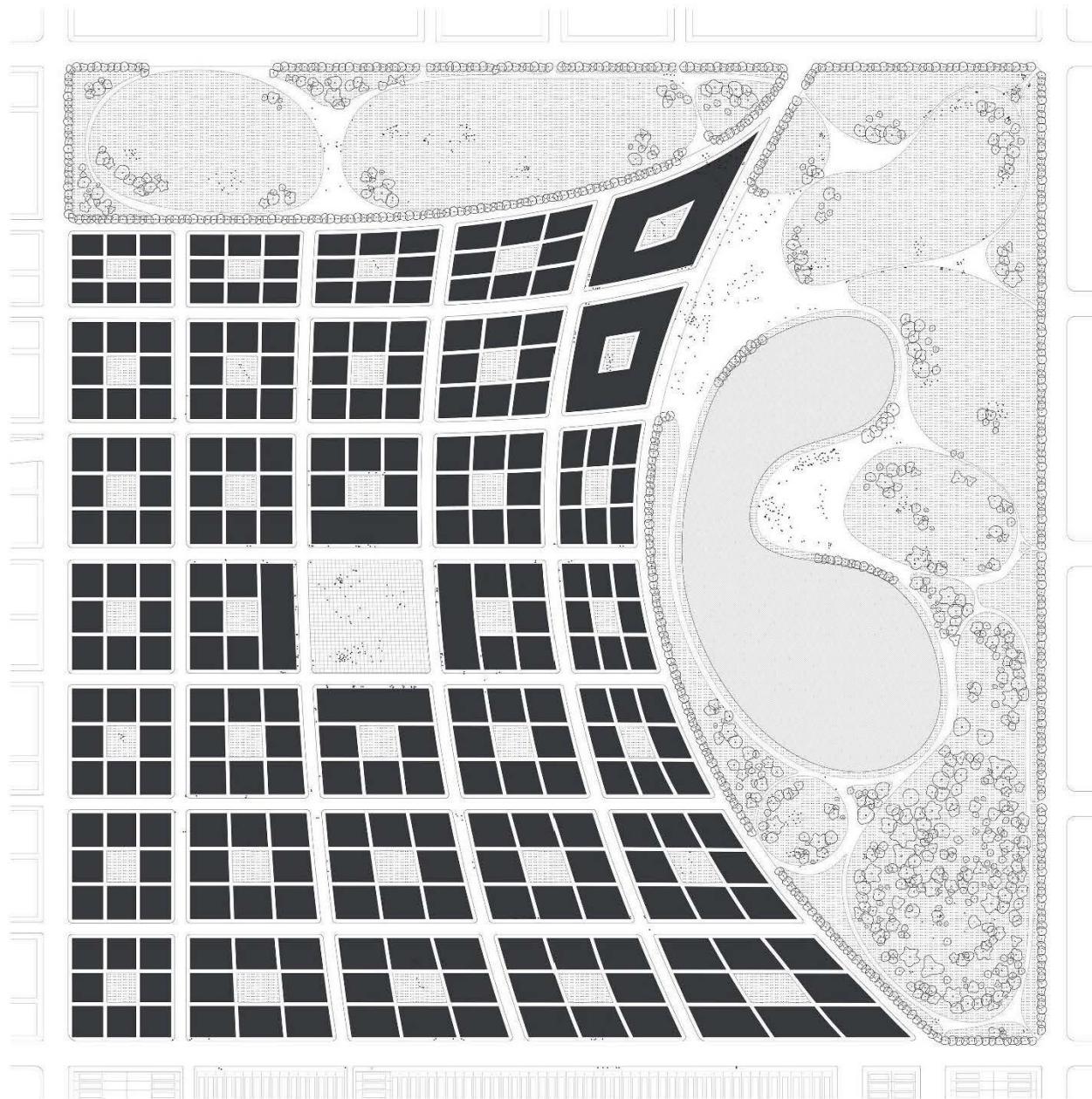

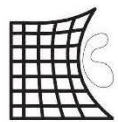

SEWING THREAD

Asuka Fujita

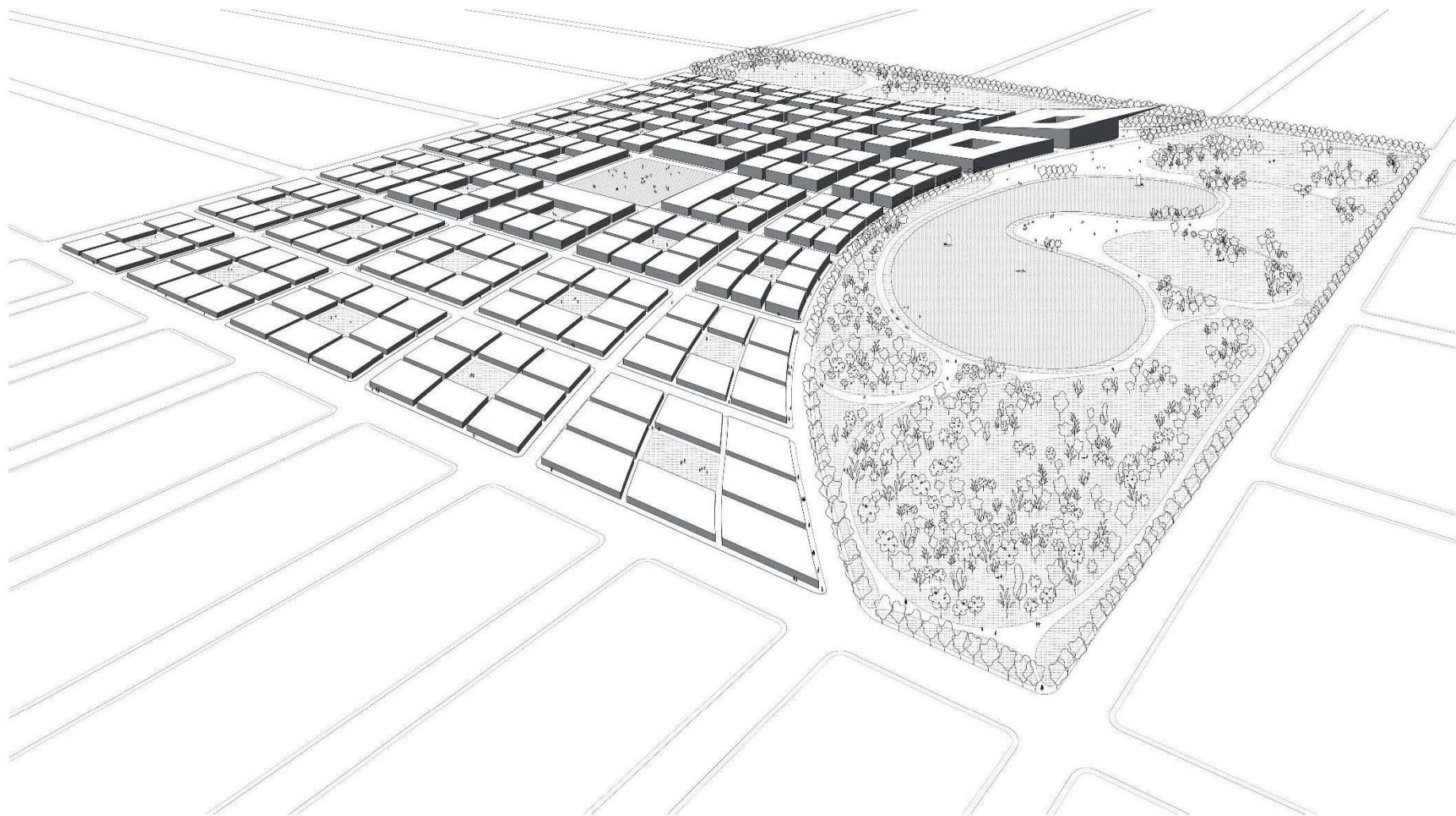

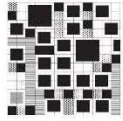

PIAX

Rachel Chen

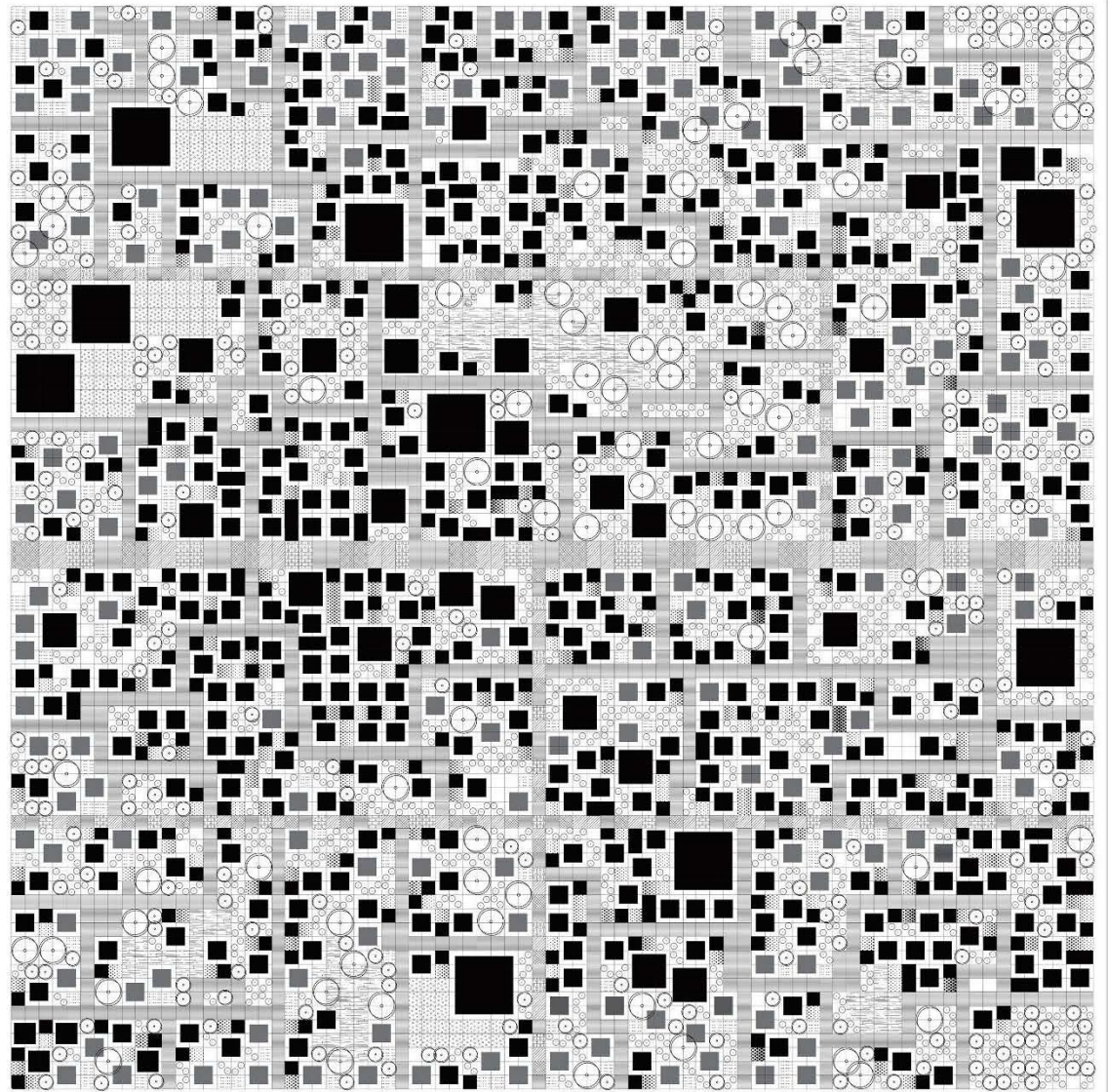

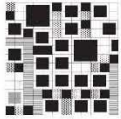

PIAX

Rachel Chen

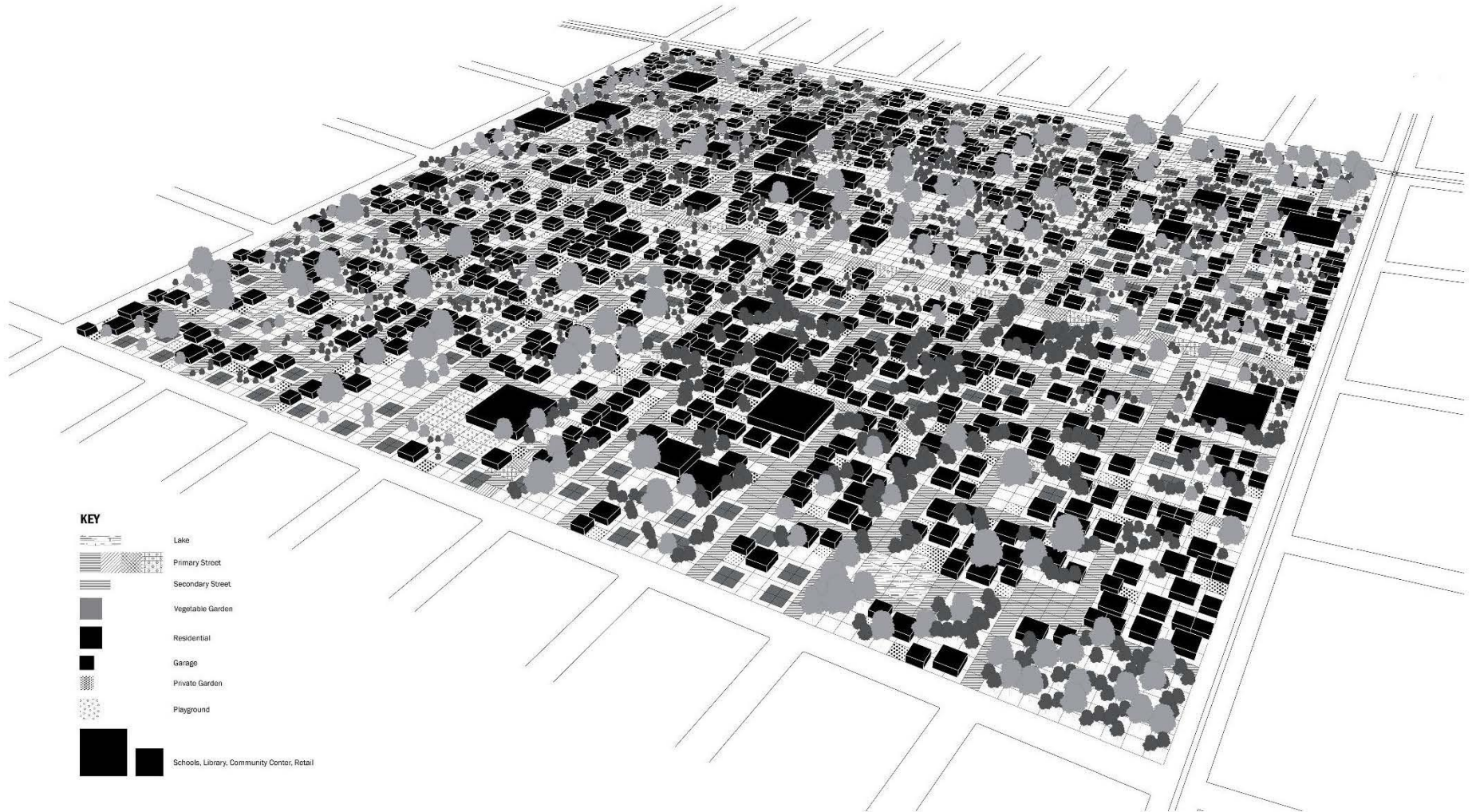

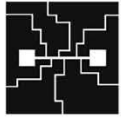

HIDDEN PASSAGE

David Lin

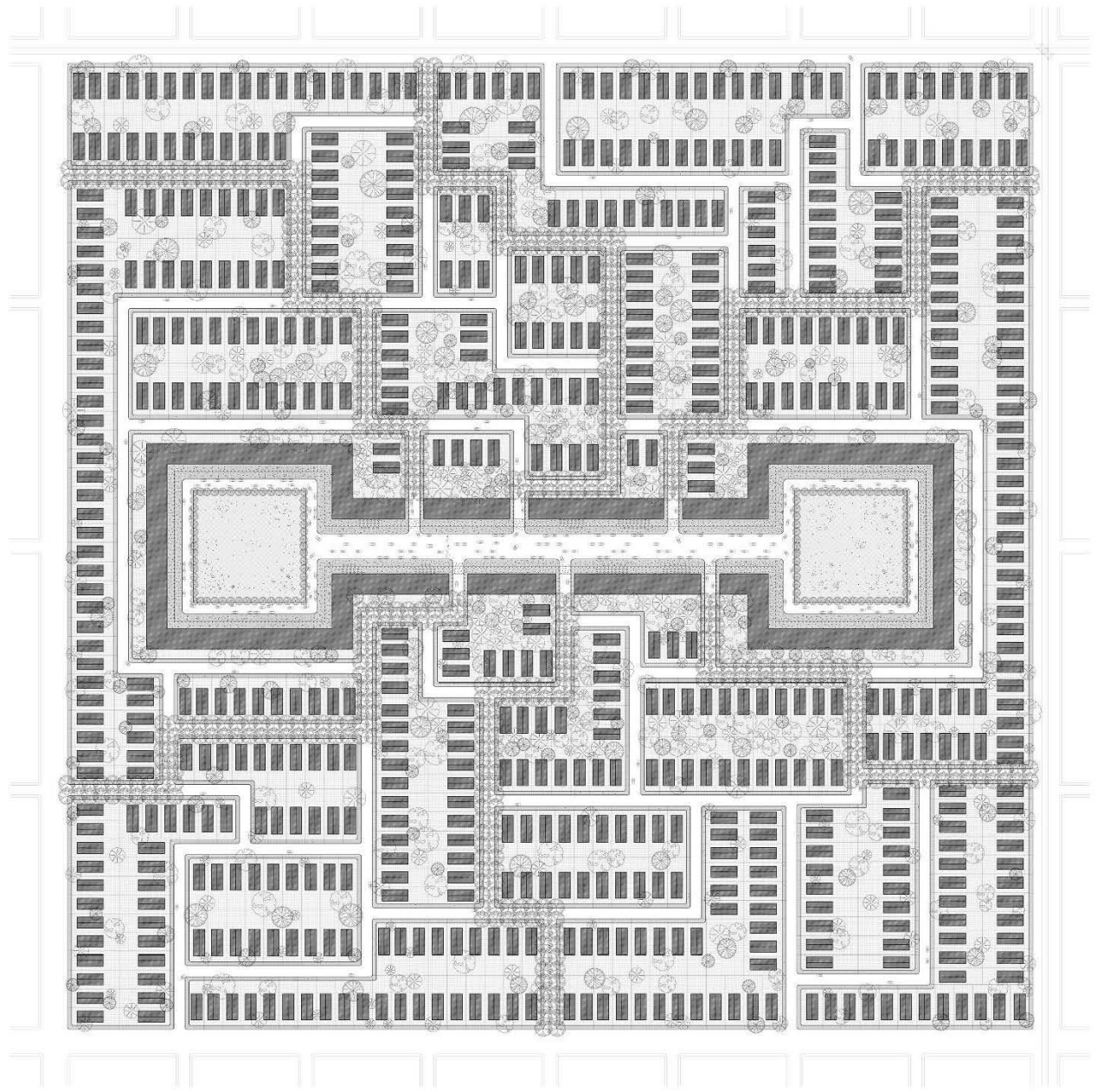

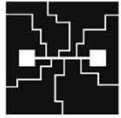

HIDDEN PASSAGE

David Lin

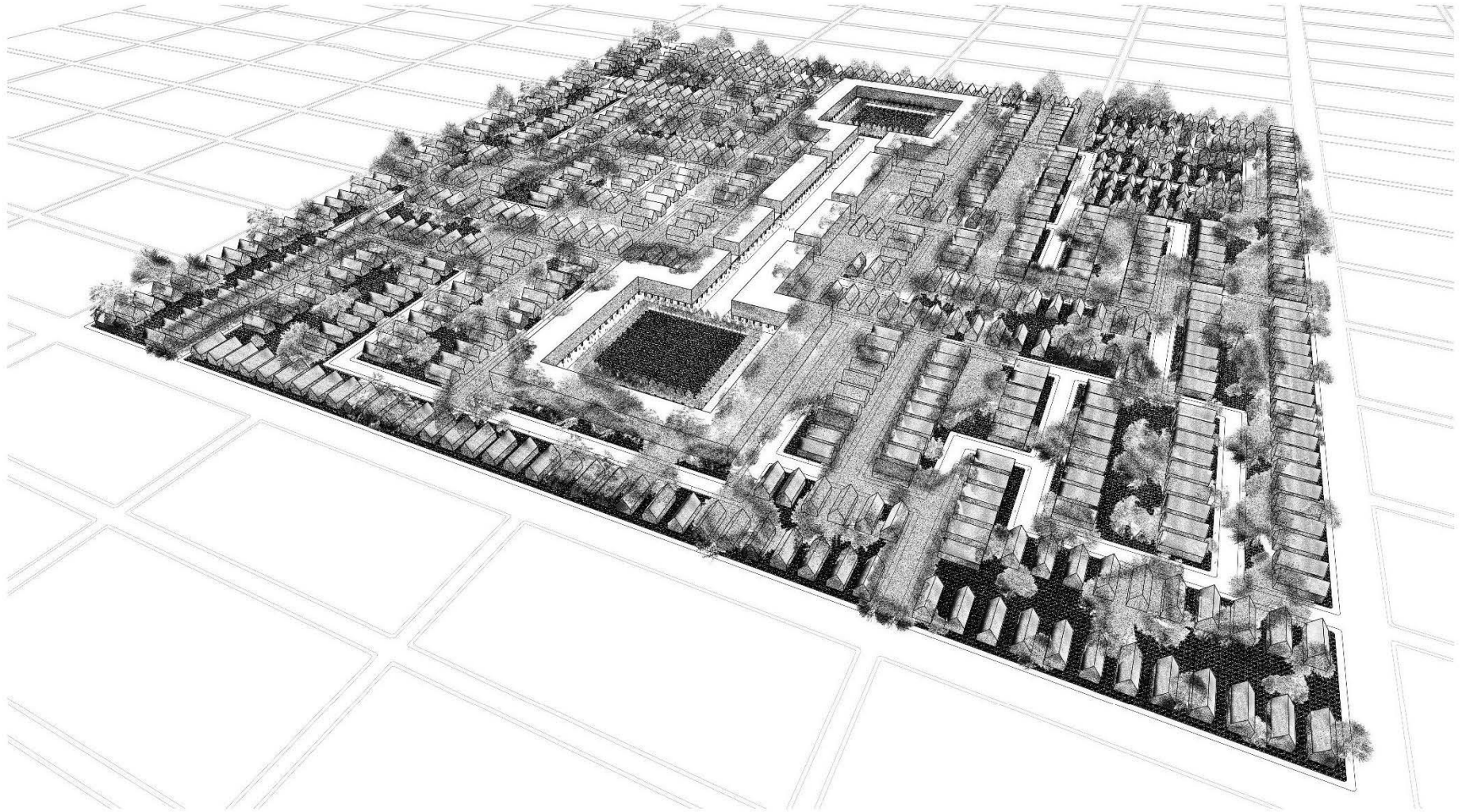



re(PROUN)

Patrick Niedzwiecki

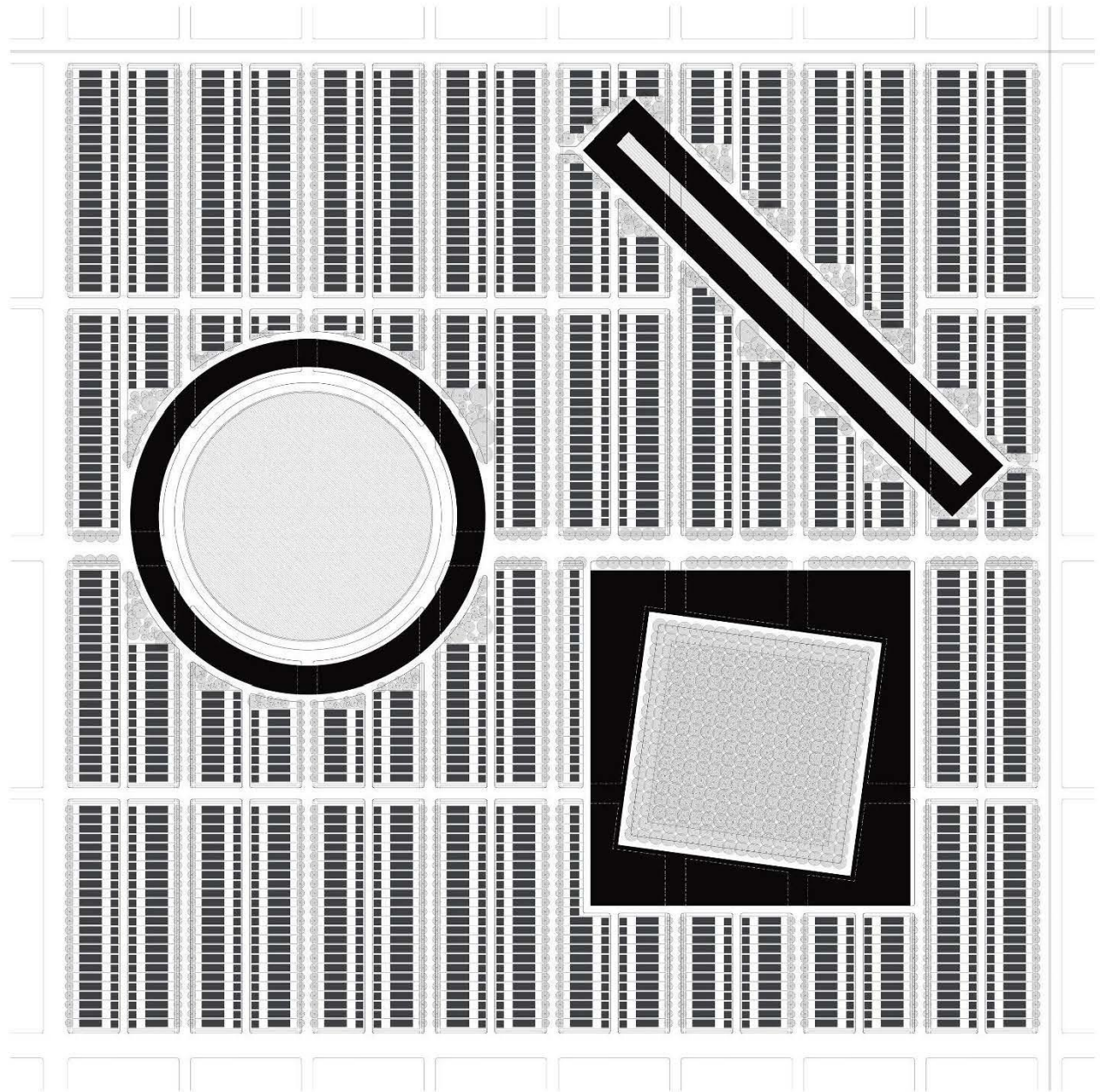



re(PROUN)

Patrick Niedzwiecki

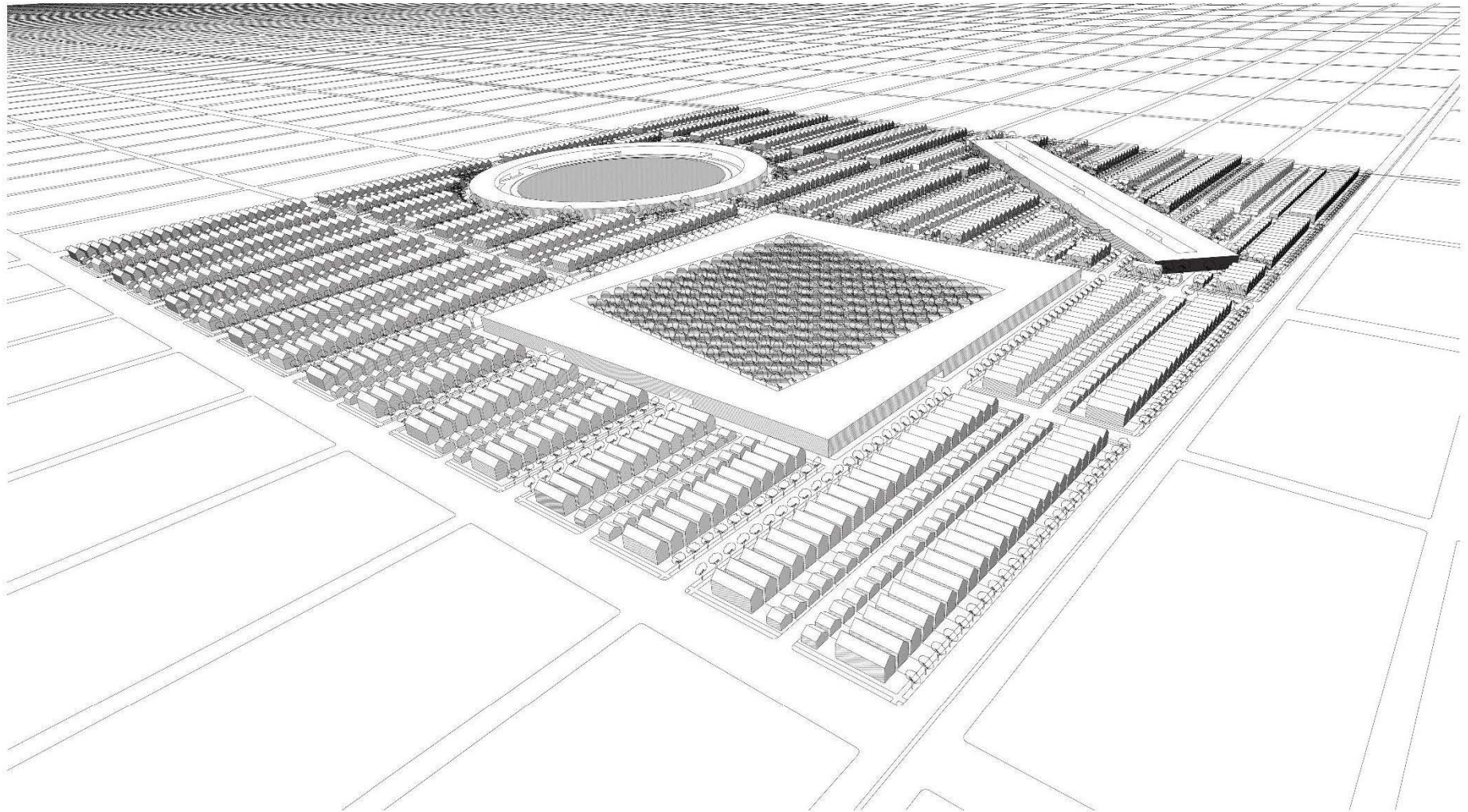

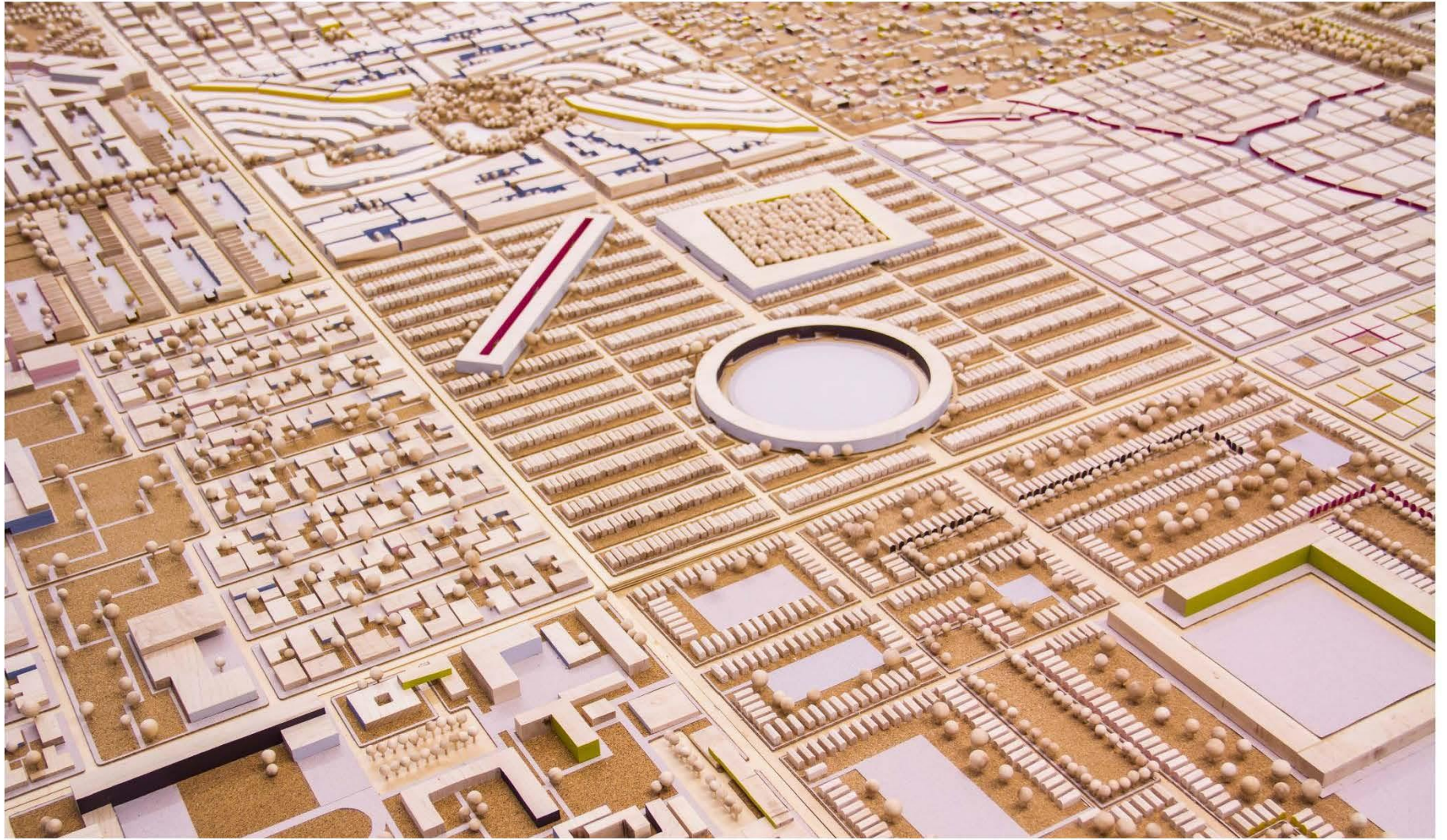

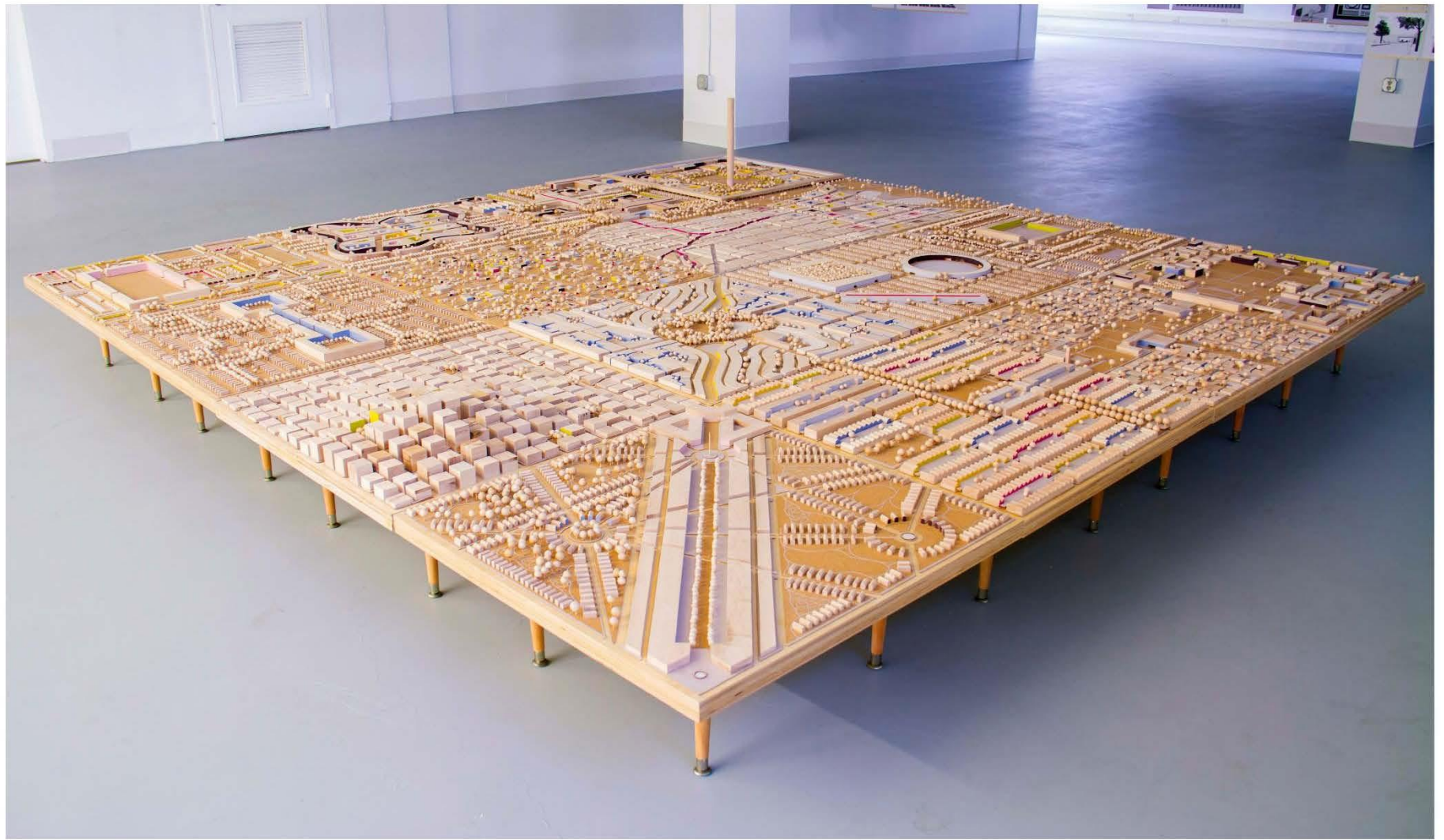



The Studio Prize is proudly sponsored by Sloan.

SLOAN.

INTRODUCTION BY SARA JOHNSON
TEXT BY CLAY RISEN

Typically this magazine focuses on extraordinary work by established professionals, but even the most famous architects start somewhere. The new Studio Prize recognizes a quieter, yet equally significant force in architecture: the studio course. The bedrock of architecture education, studios allow future generations of architects to learn through action, explore the central issues of architectural practice, and take risks with relative impunity. Studios also serve as a research lab for instructors, who craft design problems for their students that will push conceptual boundaries and test pragmatic hypotheses.

This year's Studio Prize jury comprised three noted practitioners with exceptional academic credentials: Jeanne Gang, FAIA; Jimenez Lai; and Bernard Tschumi, FAIA. After reviewing 151 submissions from more than 80 schools, the jurors chose six courses for recognition and a share of the \$25,000 purse provided by the program's sponsor, Sloan. One winner received the Sloan Award, which celebrates thoughtful takes on sustainability. The cash goes to those students whose work the instructors chose to submit; no more than five projects per course were admissible.

Overall, the work showcased in these pages reflects the innovation and foresight of seven educators and 47 students, and provides a glimpse into the formation of ideas that will define architecture in the coming decades.

Jeanne Gang, FAIA, is the founder of Chicago-based Studio Gang Architects and a MacArthur Fellow. She has taught at the Illinois Institute of Technology and at Harvard, Yale, Princeton, Rice, and Columbia universities.

Jimenez Lai is the founder of Bureau Spectacular in Los Angeles, a faculty member at the University of California, Los Angeles, and author of *Cloisters of No Place: An Architectural Graphic Novel* (Princeton Architectural Press, 2012).

Bernard Tschumi, FAIA, is the founder of his eponymous New York- and Paris-based firm. He was dean of the Graduate School of Architecture, Planning and Preservation at Columbia from 1986 to 2003 and remains a professor there.

Haley Hartmans





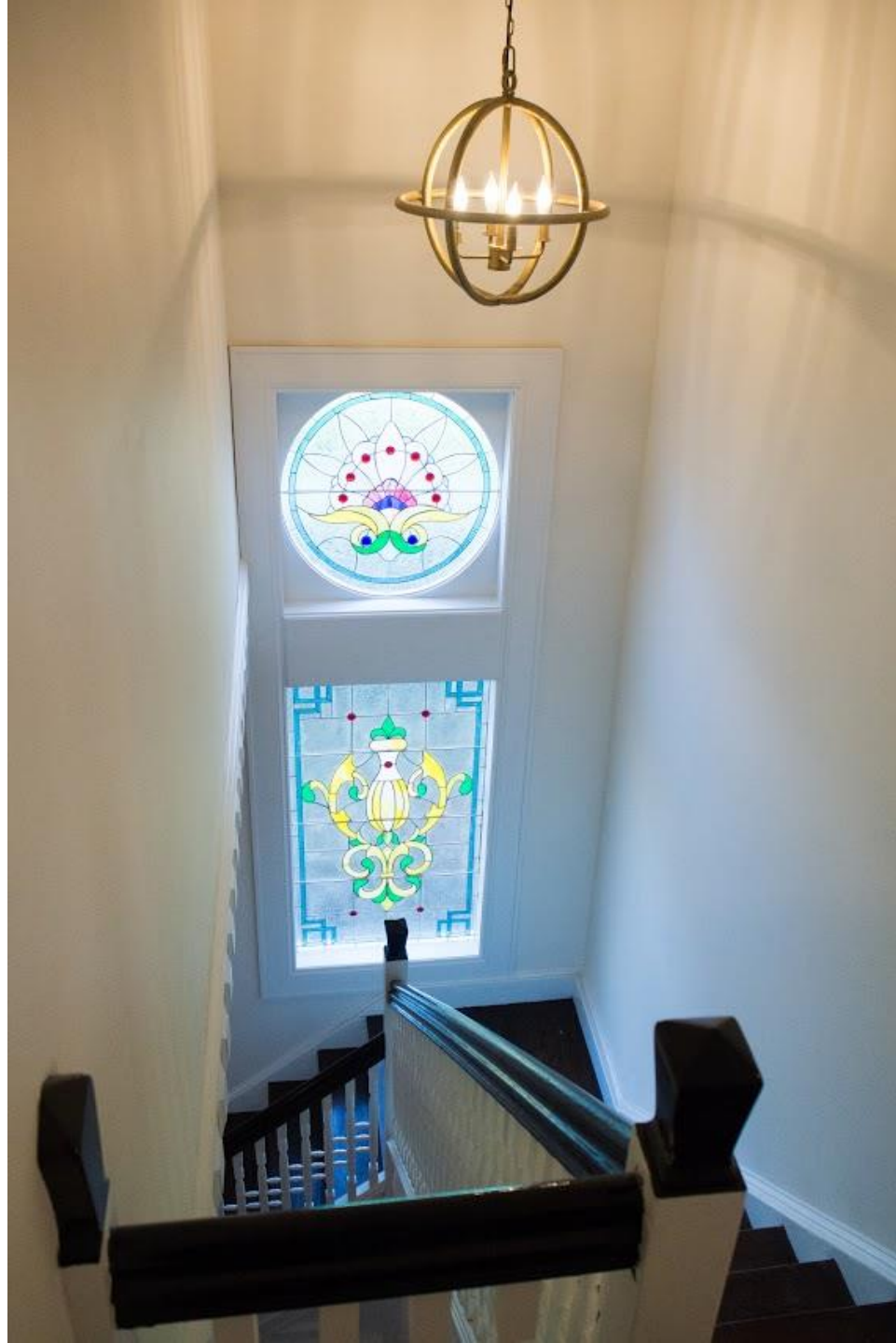

























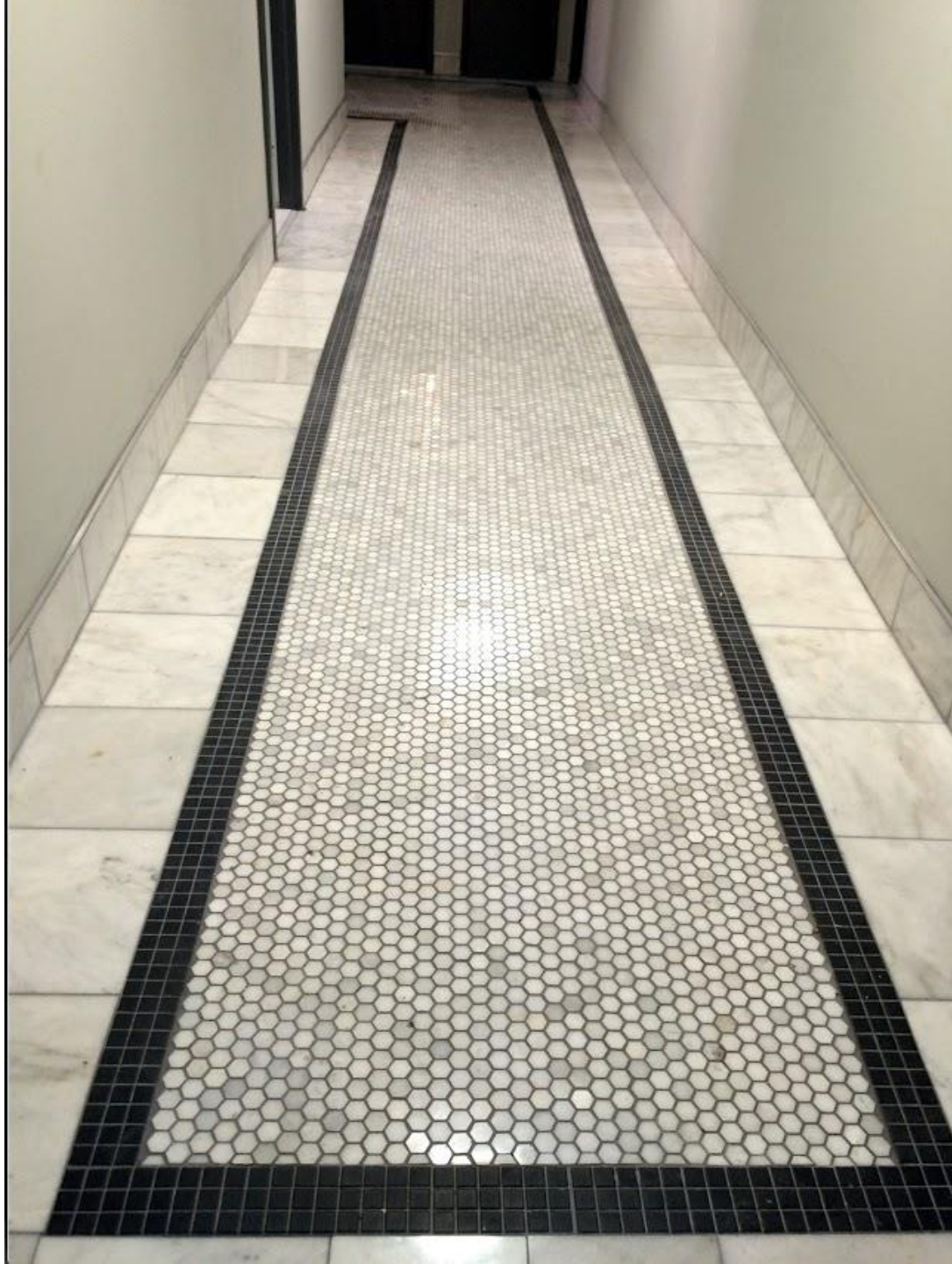





Robert Stark





AQUA BUS TO VETERANS
MEMORIAL PARK

NEW RAMP FOR
PUDDLEDUCKS

PUDDLEDUCK
STORAGE

MARINE-GRADE
WIND PROPELLORS

NEW FENCE SECTION

EXISTING USCG PICNIC
SHELTER TO BE CONVERTED
TO MARGARET L. WENDT SEASIDE
SCIENCE PAVILION

FITNESS DOME

9 MODEL 'FISHERMAN' HUTS: CRAFT ROOMS,
CAFE, LEMONADE STAND, LIBRARY

APPROXIMATE CURRENT
PROJECT BOUNDARY
(APPROX. 1.729 AC. OR 75,310 S.F.)

SCIENCE PONTOON BOAT

ZODIACS

DINGHY
LAUNCHES

KAYAK LAUNCH

FLOATING DOCK
W/ RAMP

MISS CLARA
BROWN
HISTORIC
LANDMARK

FLOATING
ECOCLASSROOM

INTERPRETIVE CENTER

PORTABLE RESTROOM

KAYAK RACK

BIKE RACK

SURF SHACK

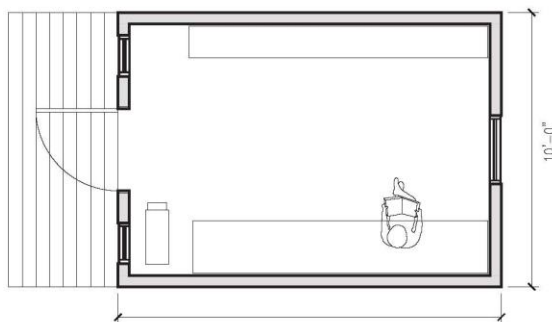
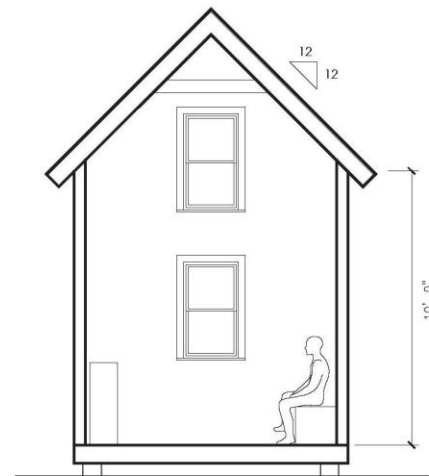
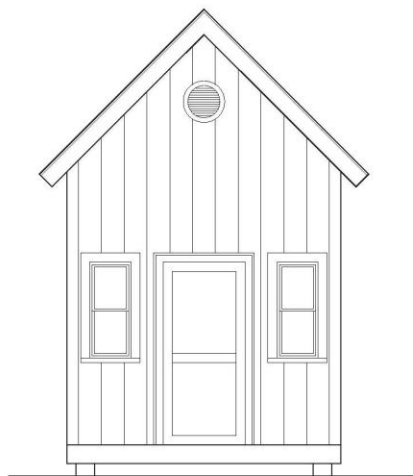
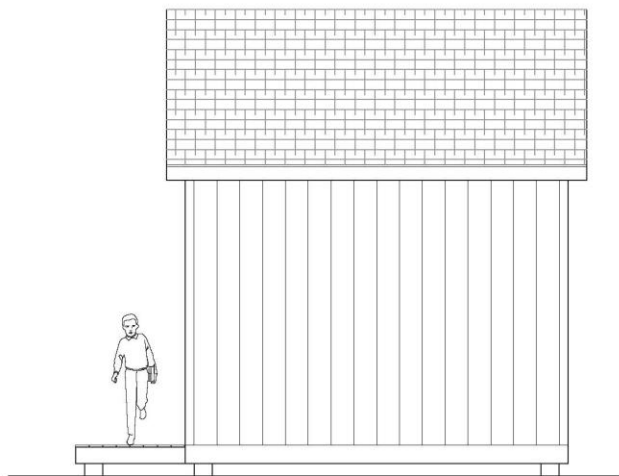

INSPIRED BY HISTORIC BUFFALO RIVER SHANTIES
AND SCANDINAVIAN FISHERMAN HUTS. THEY WILL
PROVIDE SPACE FOR CRAFT AND ACTIVITY ROOMS,
A LIBRARY, LEMONADE STAND AND A CAFE



© Joe George
UrbanSimplicity.com



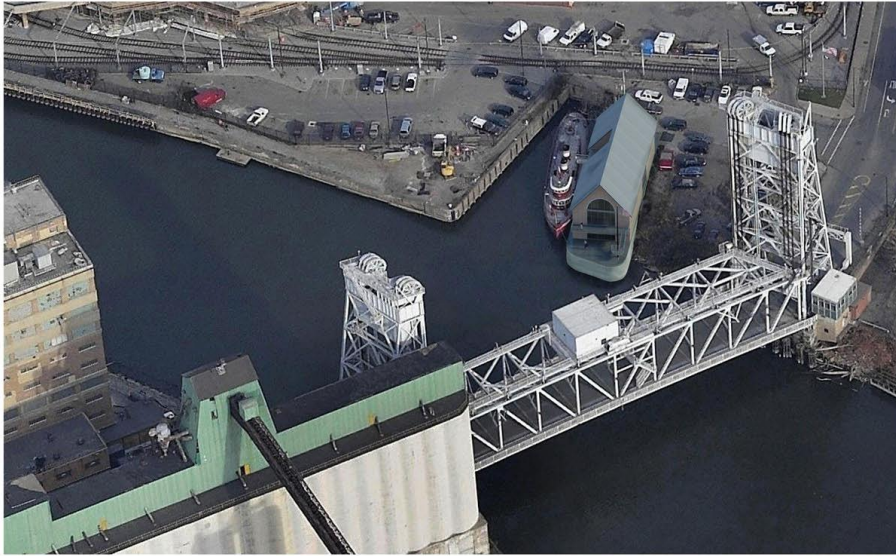

AERIAL VIEWS

CHAI NTREUIL | JENSEN | STARK

FRIENDS OF
The EDWARD M. COTTER



PERSPECTIVE VIEW

CHARENTREUIL | JENSEN | STARK

FRIENDS OF
The **EDWARD M. COTTER**

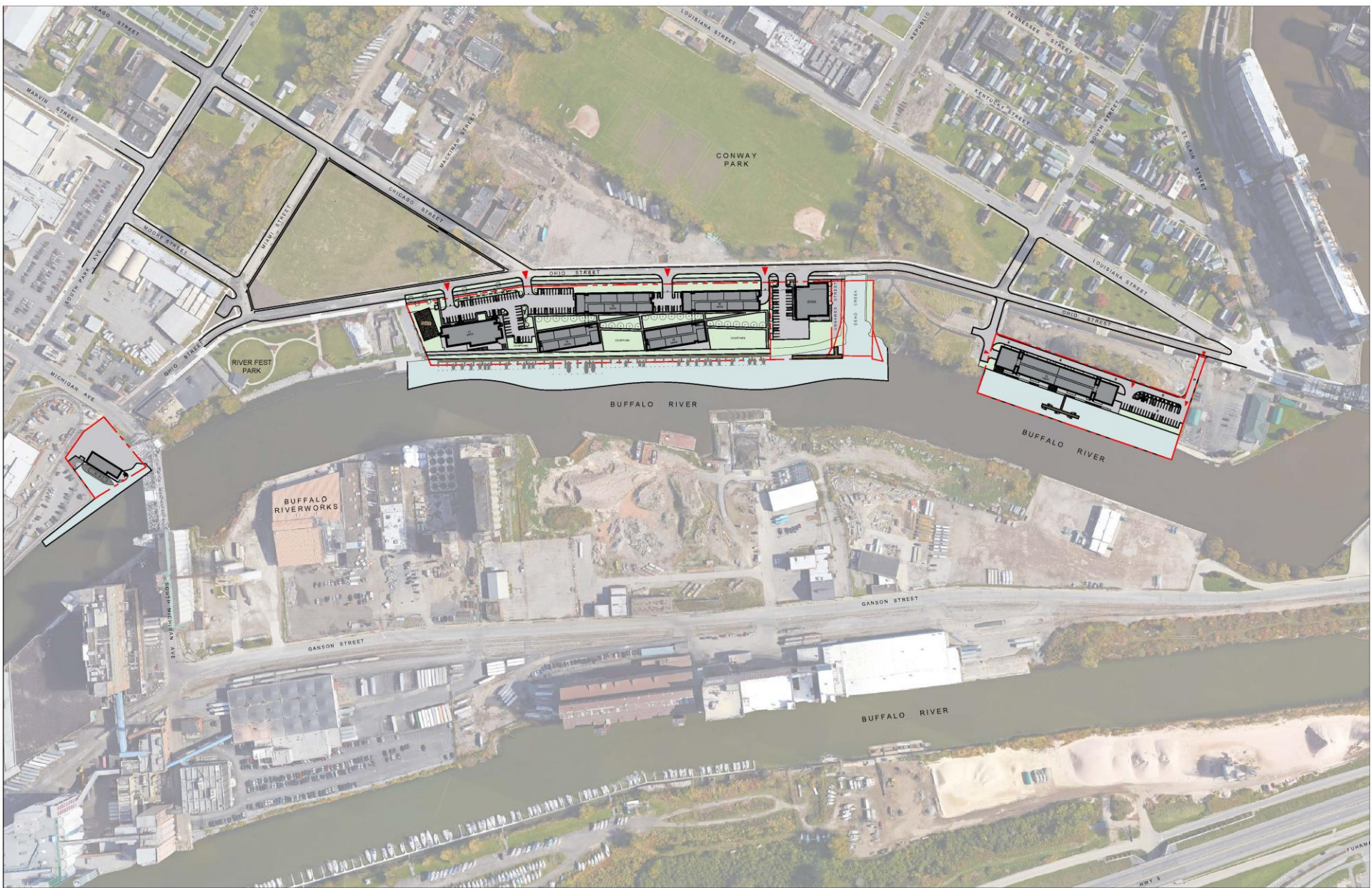







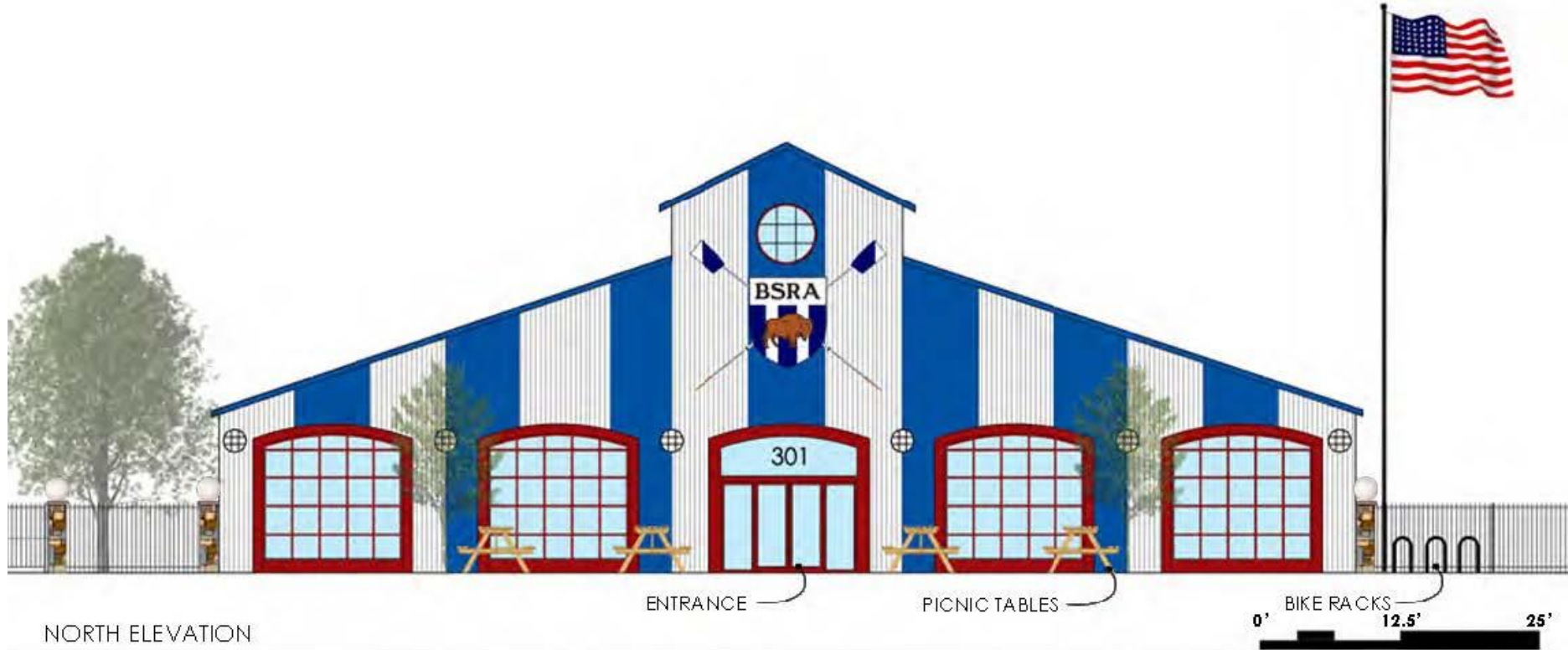











BUILDING ELEVATION

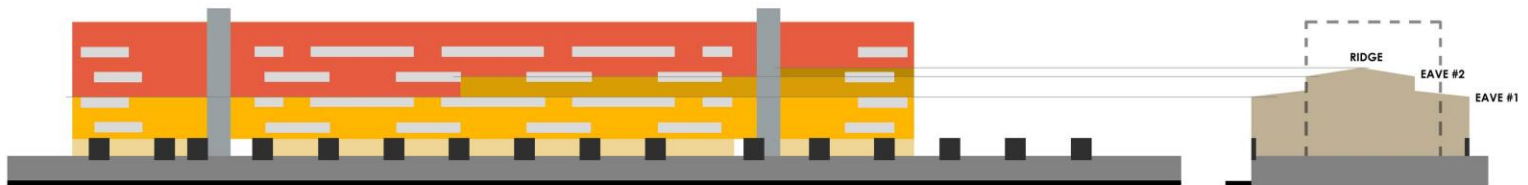

ELEVATION DIAGRAM

- ZONE 3** - UPPER LEVEL - FLAT PANEL COR-TEN
- ZONE 2C** - RIBBED COR-TEN (REFERENCES FREIGHT HOUSE RIDGE)
- ZONE 2B** - RIBBED COR-TEN (REFERENCES FREIGHT HOUSE EAVE #2)
- ZONE 2A** - RIBBED COR-TEN (REFERENCES FREIGHT HOUSE EAVE #1)
- ZONE 1** - LOWER LEVEL - PERFORATED & RIBBED COR-TEN
- REFERENTIAL 'DOORS'** - LOCATED AT RIVER EDGE

- EXISTING FREIGHT HOUSE
- PROPOSED NEW BUILDING





Rachel Adams







A Concrete Atlantis by Reyner Banham

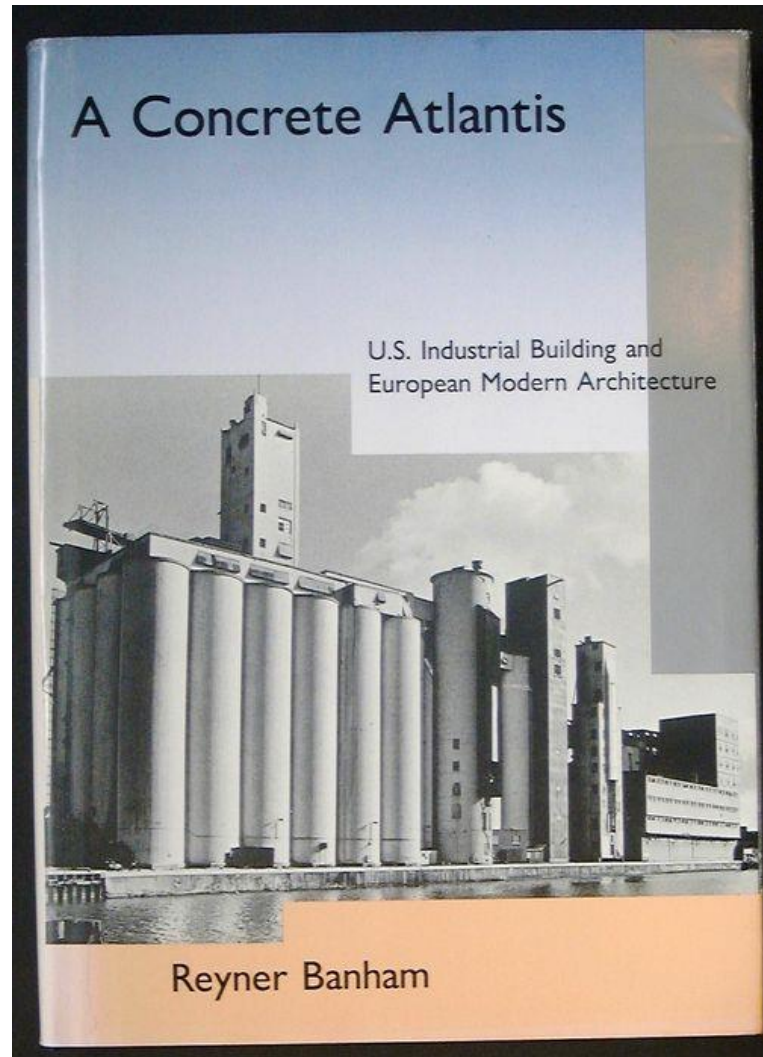

Patricia Bazelon

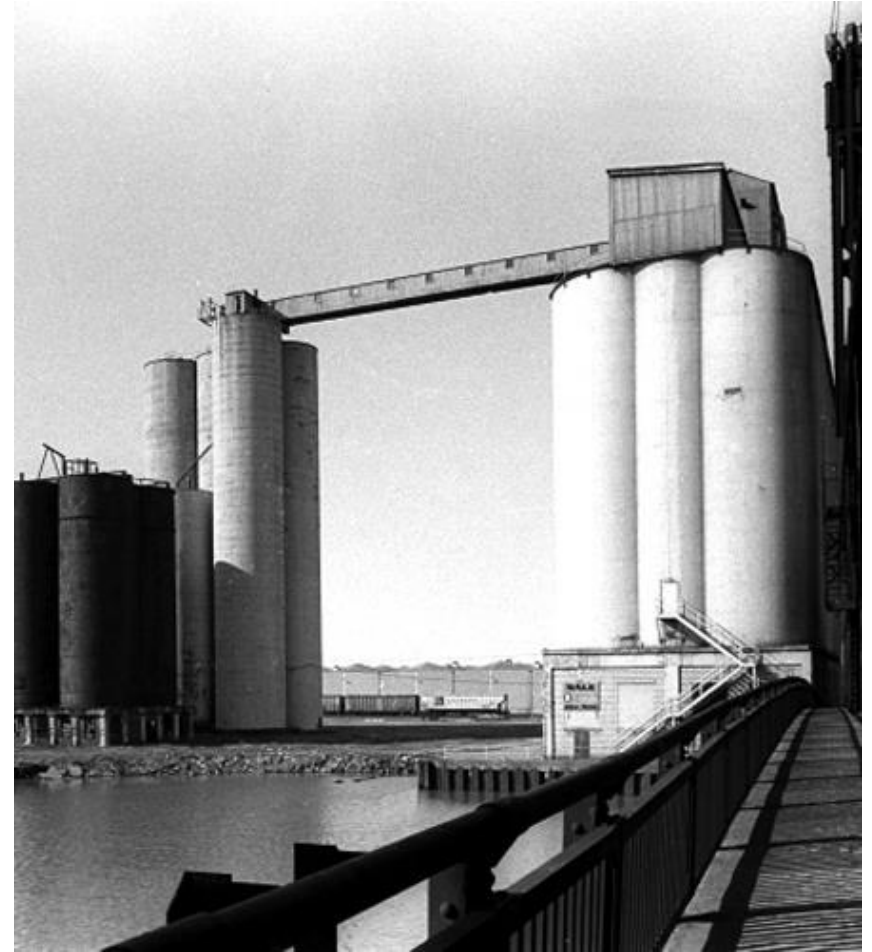
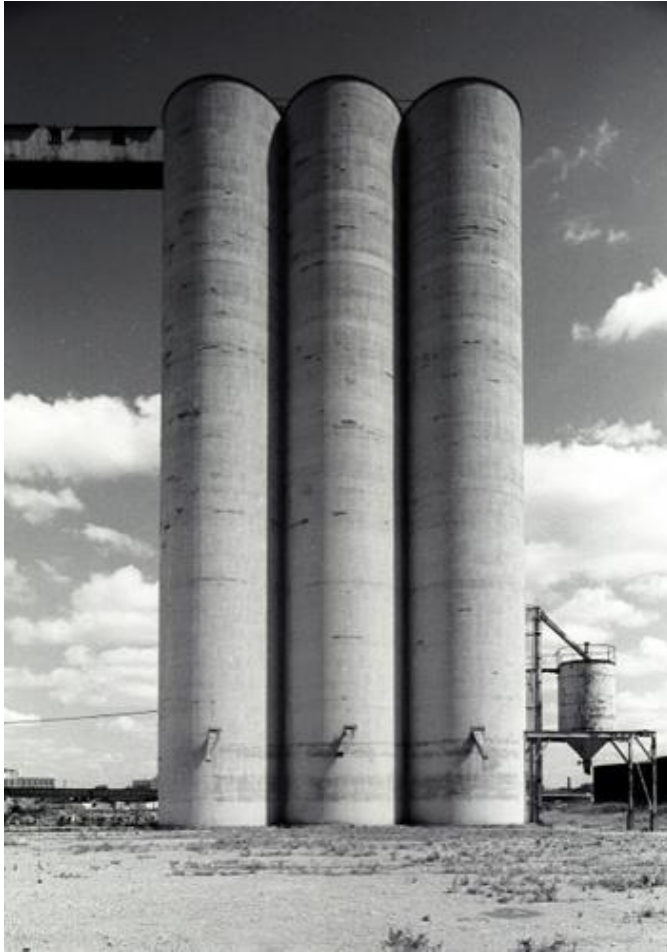

Charles Sheeler River Rouge Plant Series, 1927



Bernd & Hilla Becher



Charlotte Posenenske

Series D and Series DW



Charlotte Posenenske, *Series D*
Vierkantrohre (Square Tubes), 1967.



Seher Shah

Object Repetition: Line to Distance

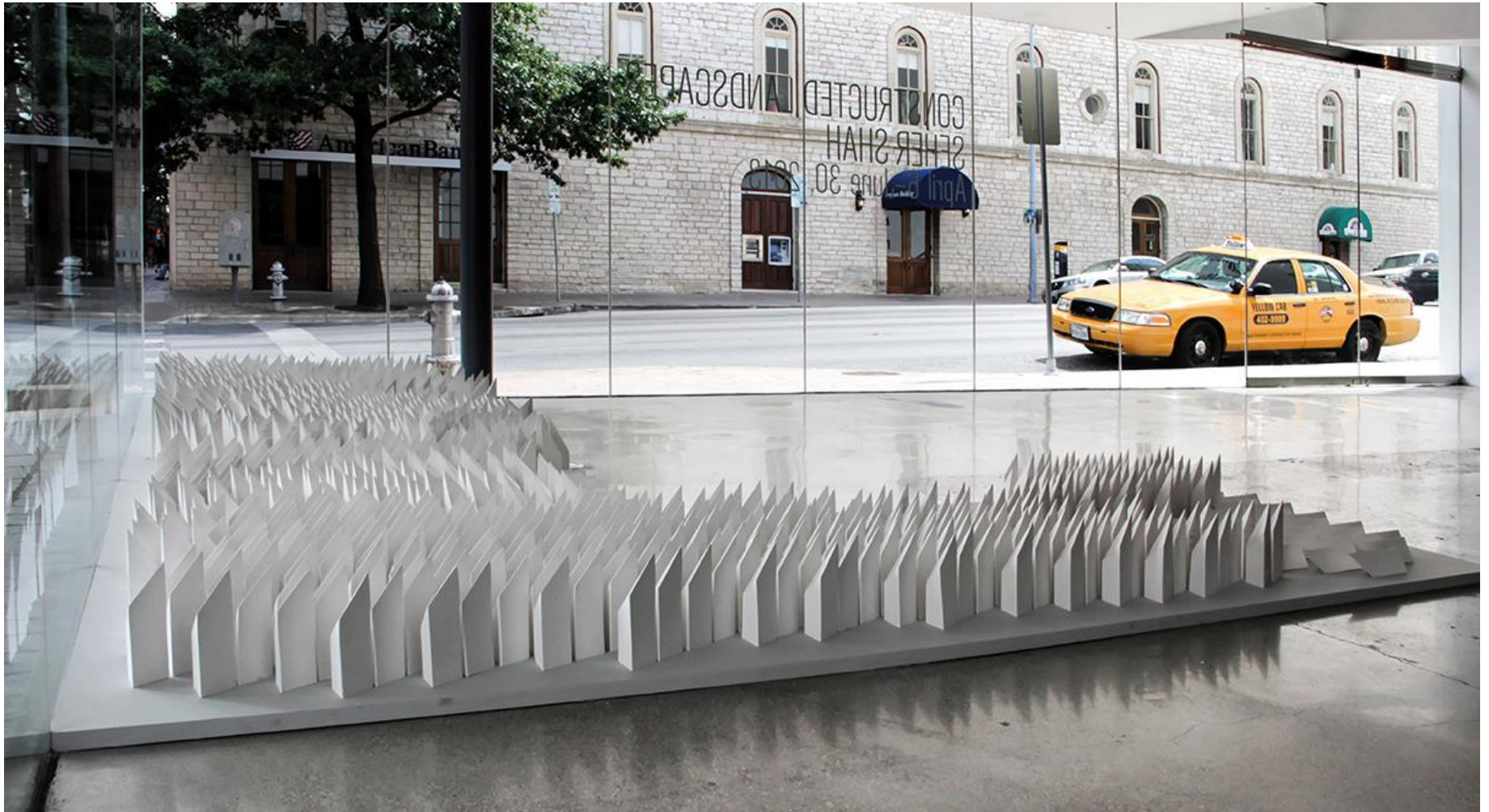

Ben Peterson



Julian Hoeber
Demon Hill Model #3



Julian Hoeber

Demon Hill



Julian Hoeber

Demon Hill



Amie Siegel Quarry



An Te Liu



City Souvenirs



“A bare practical form becomes
abstract beauty.”

- Architect Erich Mendelsohn, 1926

Joe Ebert











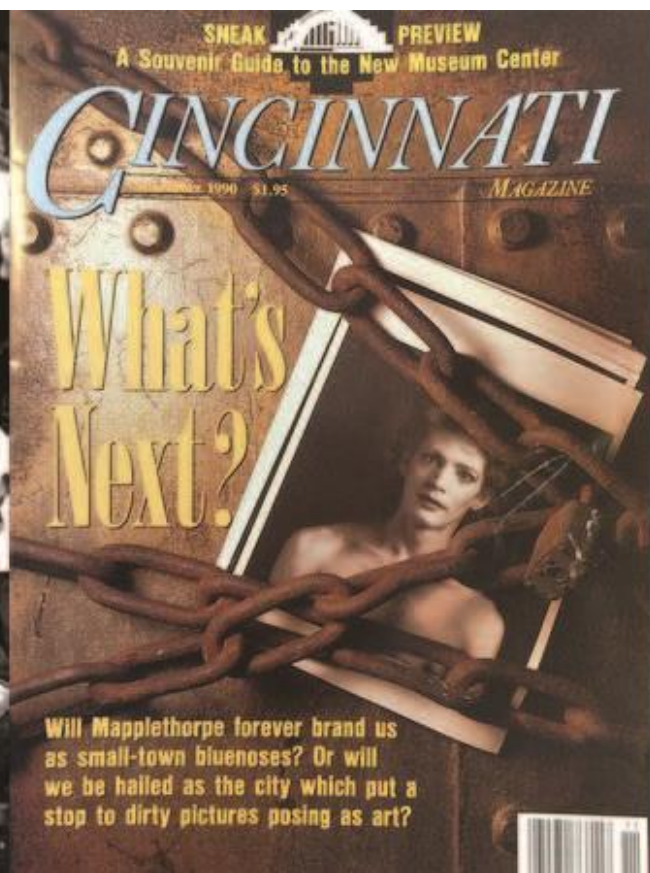



Frank Ebert, *Untitled* (2006)



Frank Ebert, *Untitled* (2010)



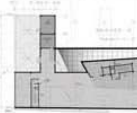
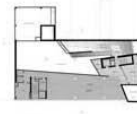
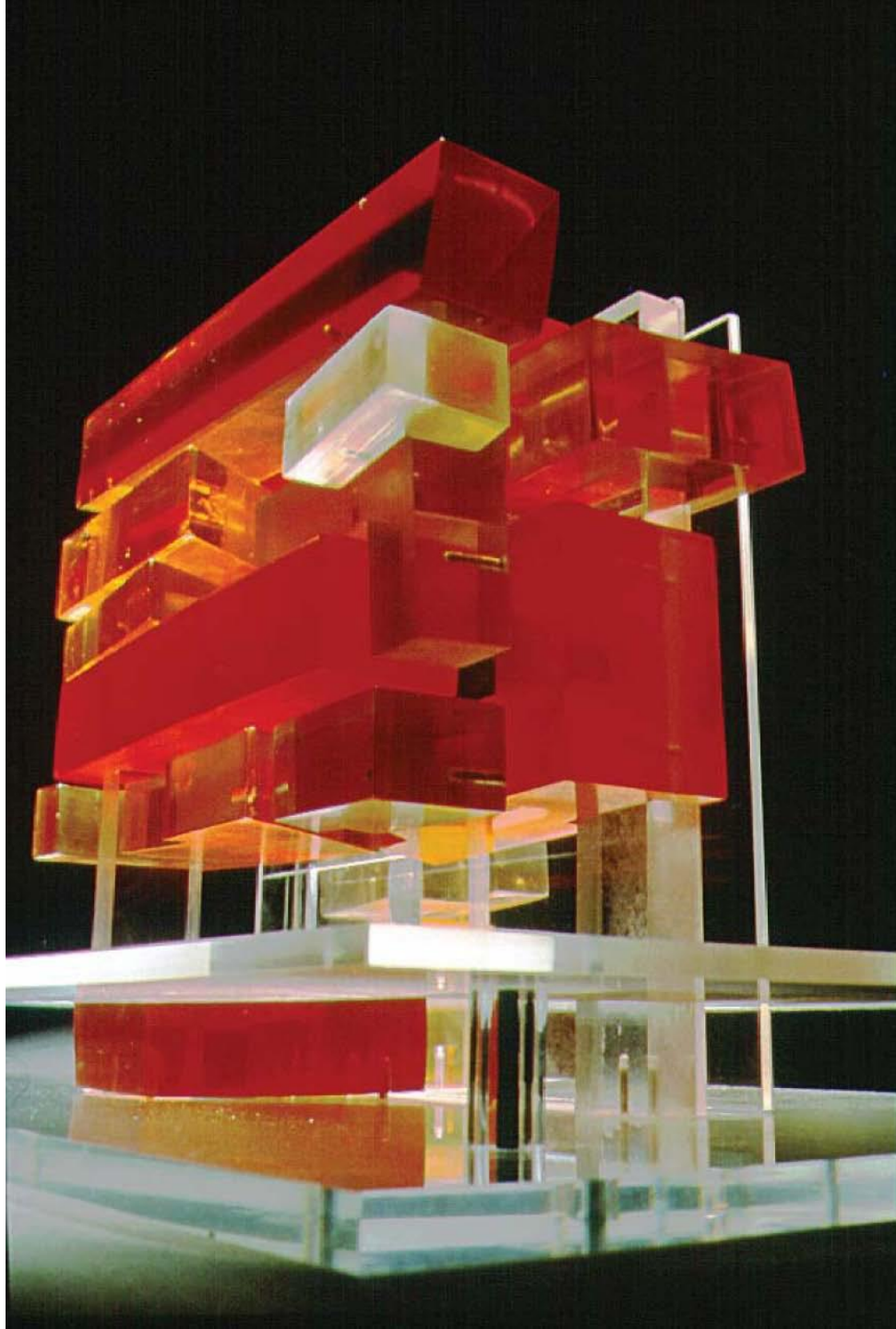















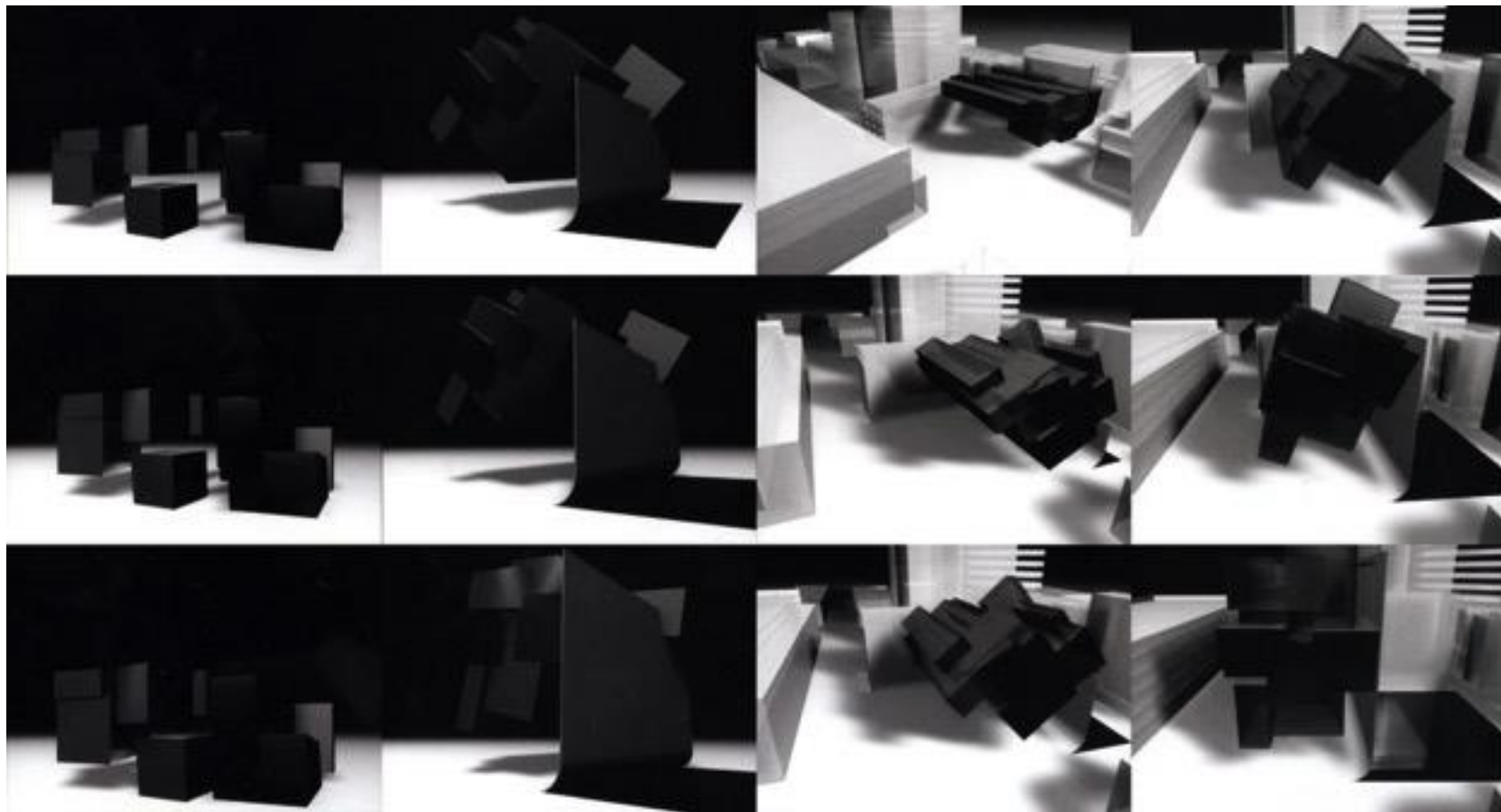



INTERMISSION

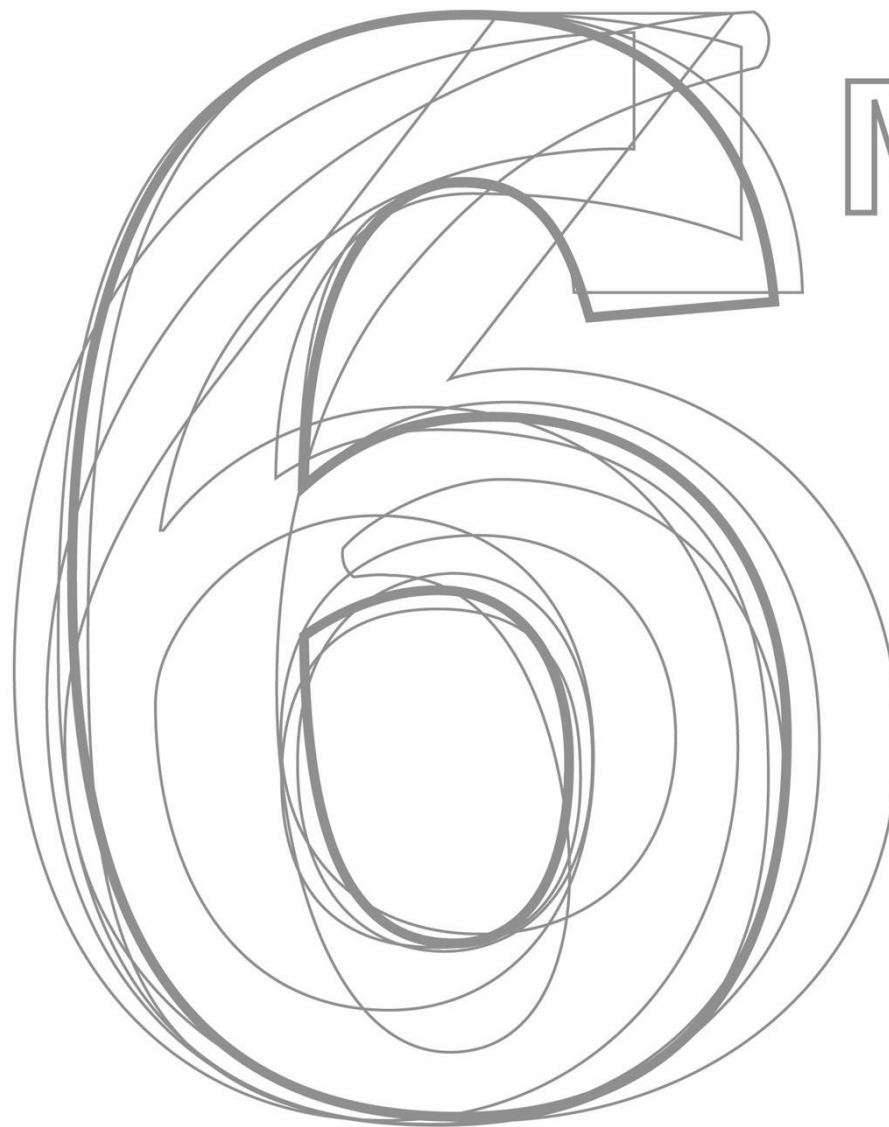

Mbs

Michael Tunkey

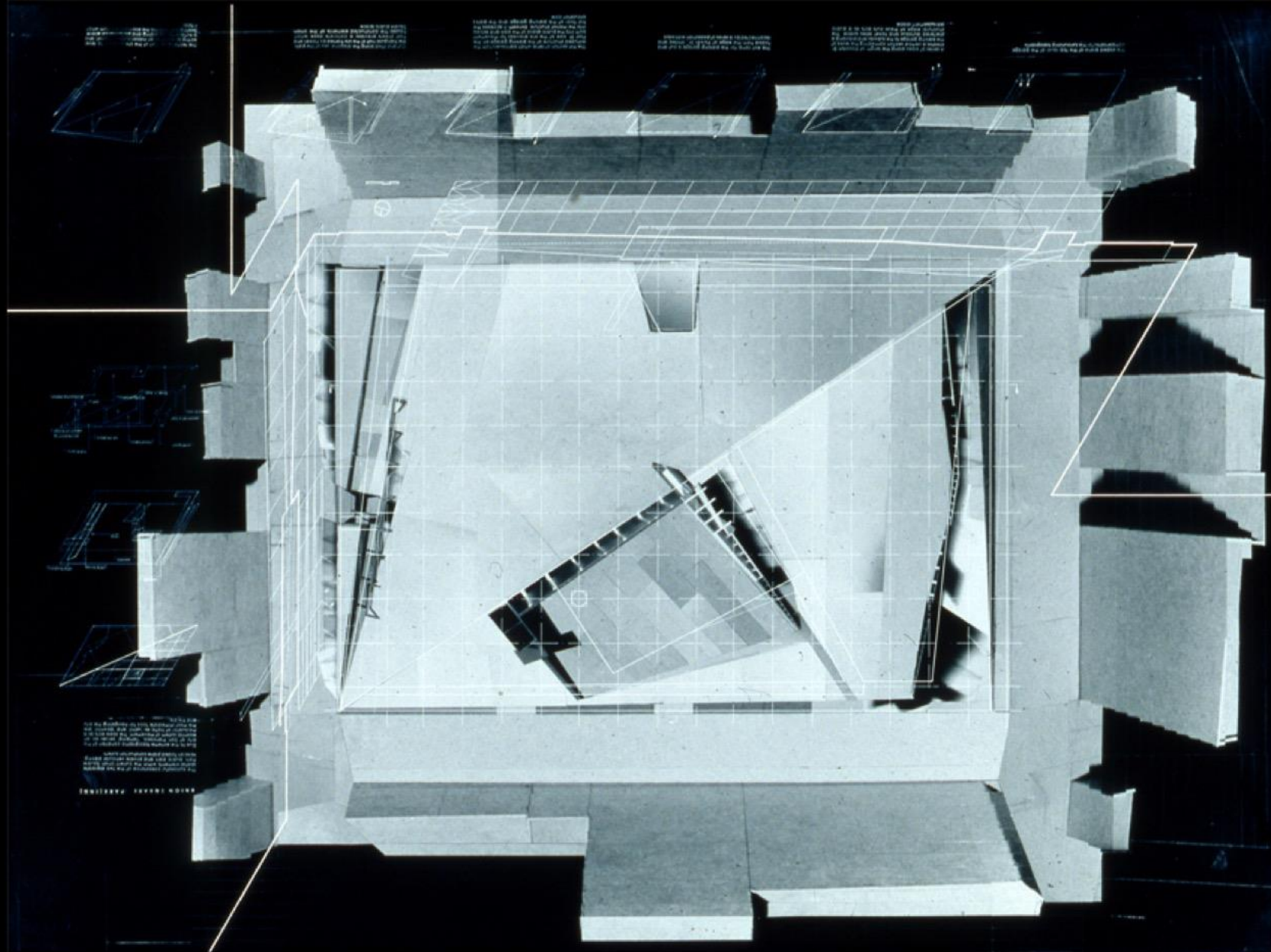

1997

SAN FRANCISCO



1997

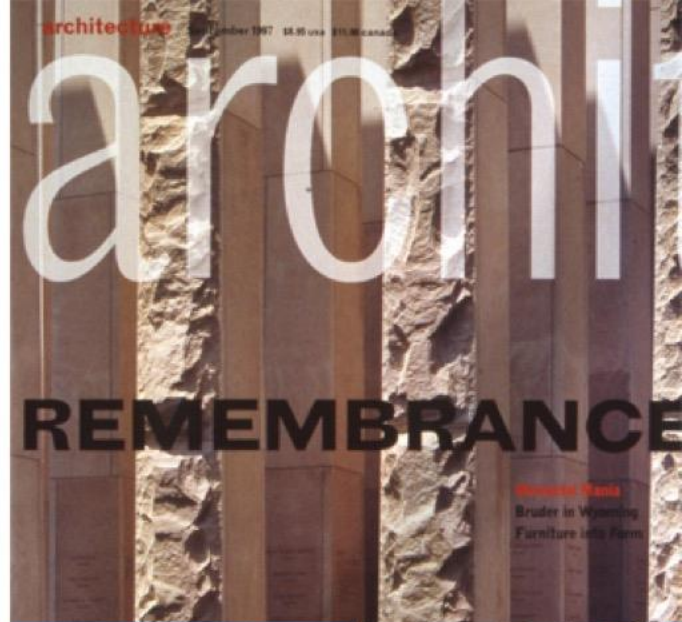

(DIS)UNION SQUARE

In August, a controversial design competition to revitalize Union Square in downtown San Francisco left jurors divided over its outcome, and the winners uncertain whether their scheme will ever be built. The winning scheme by Michael Tunkey and Rose Mendez of Buffalo-based F.M. Design would replace Timothy Pflueger's forlorn 1942 Beaux-Arts plaza, built over a parking garage, with what the jury describes as "one plane that unwraps itself over the



Aerial view of F.M. Design's winning scheme

that the five winning schemes were simply "furthering current-day design fads."

Four Bay Area designers were named as runners-up: April Philips and Michael Fotheringham; Jones, Partners: Architecture; Paul Martinez and Brian Kaufman; and Robert Edmonds.

BUFFALO



2000

NEW YORK



2002



BOSTON



2003

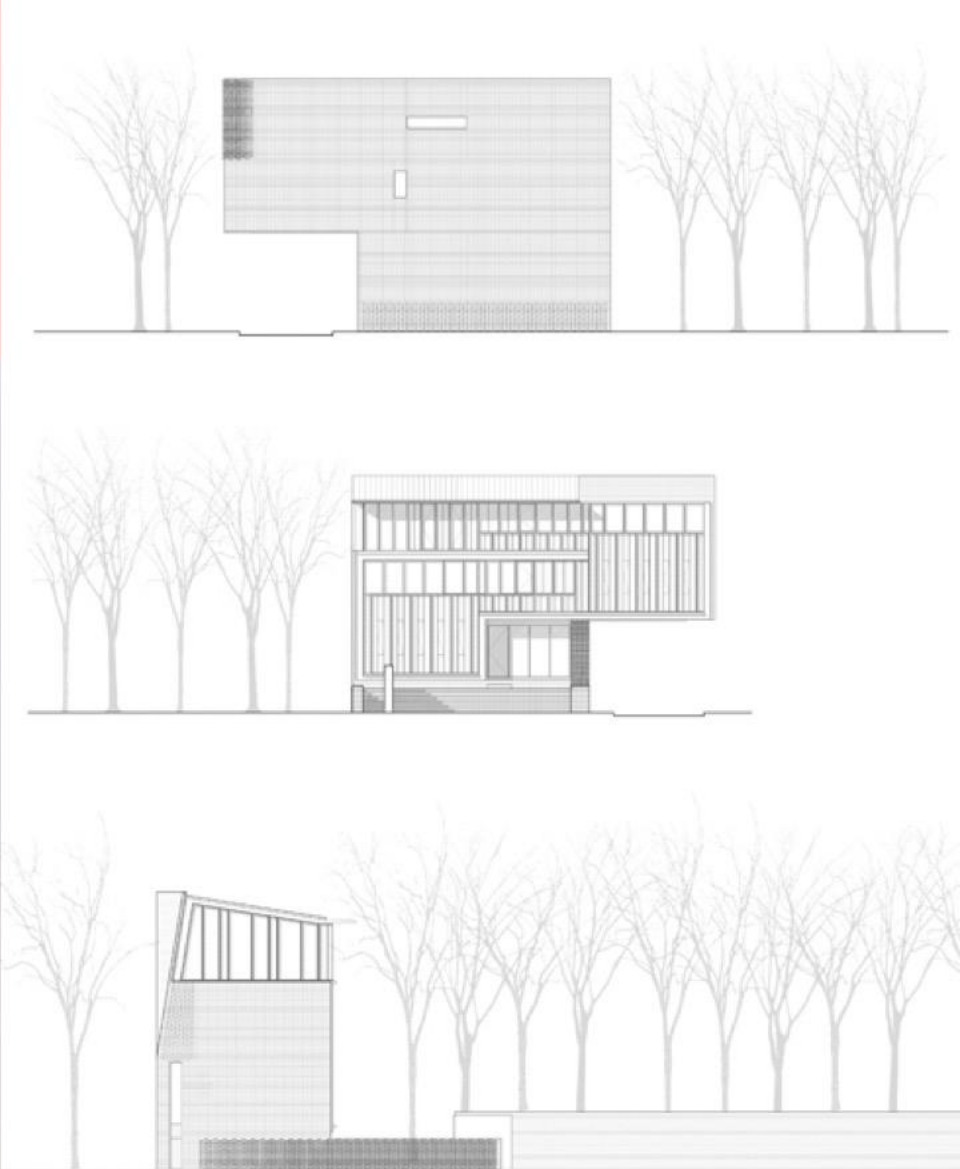

BOSTON



2003

BEIJING



2003

BEIJING



2008



ORDOS



2008

ORDOS



In Inner Mongolia, Pushing Architecture's Outer Limits

By FRED A. BERNSTEIN MAY 1, 2008



2008

ORDOS



2010



SHANDONG



2012

HAINAN



2012

SHANGHAI

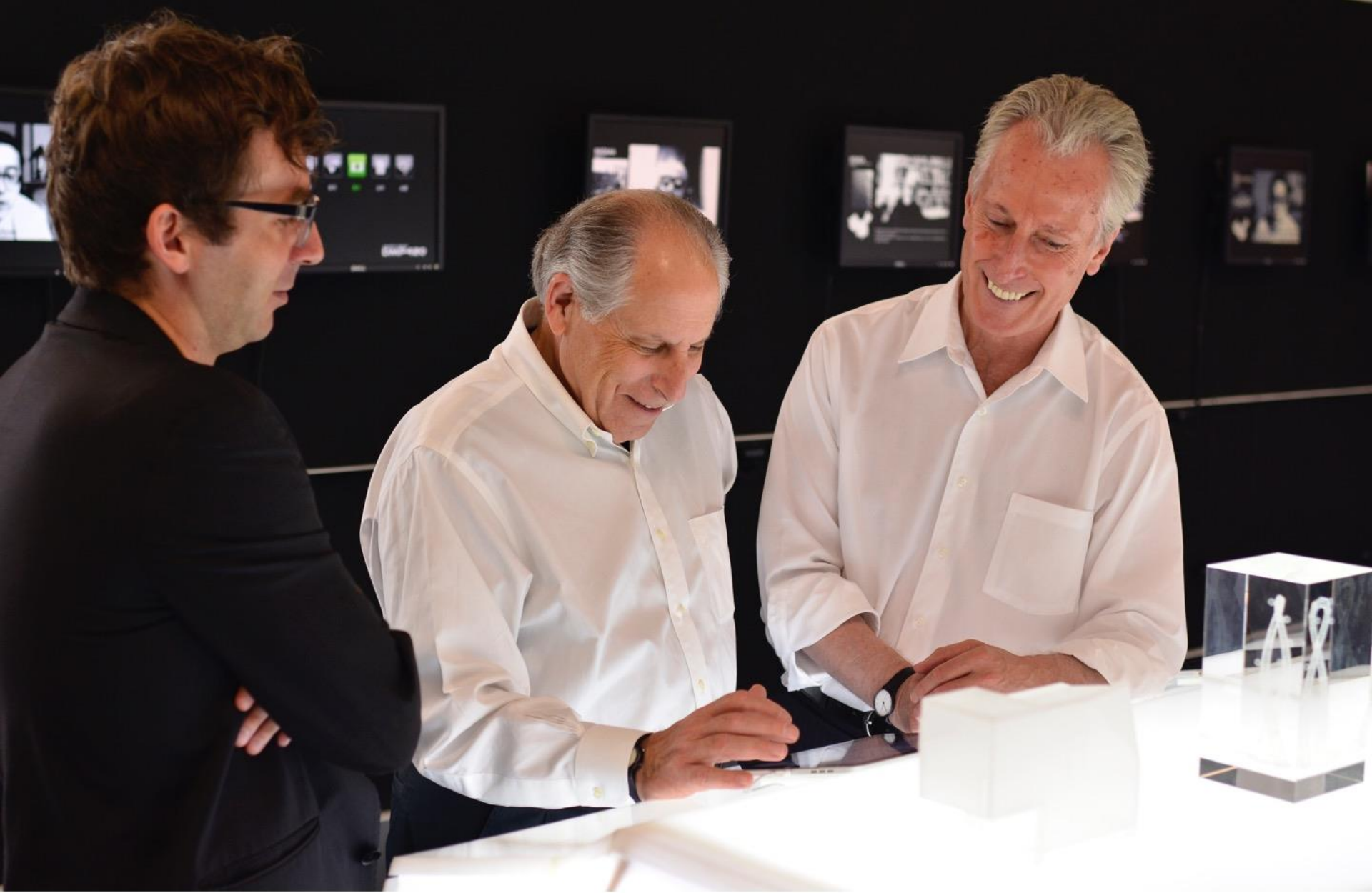

2012

SHANGHAI



2013

ASIA



2014

LUND



2015

E.AURORA



2015

E.AURORA

Sara Witschi

I ♥ Buildings

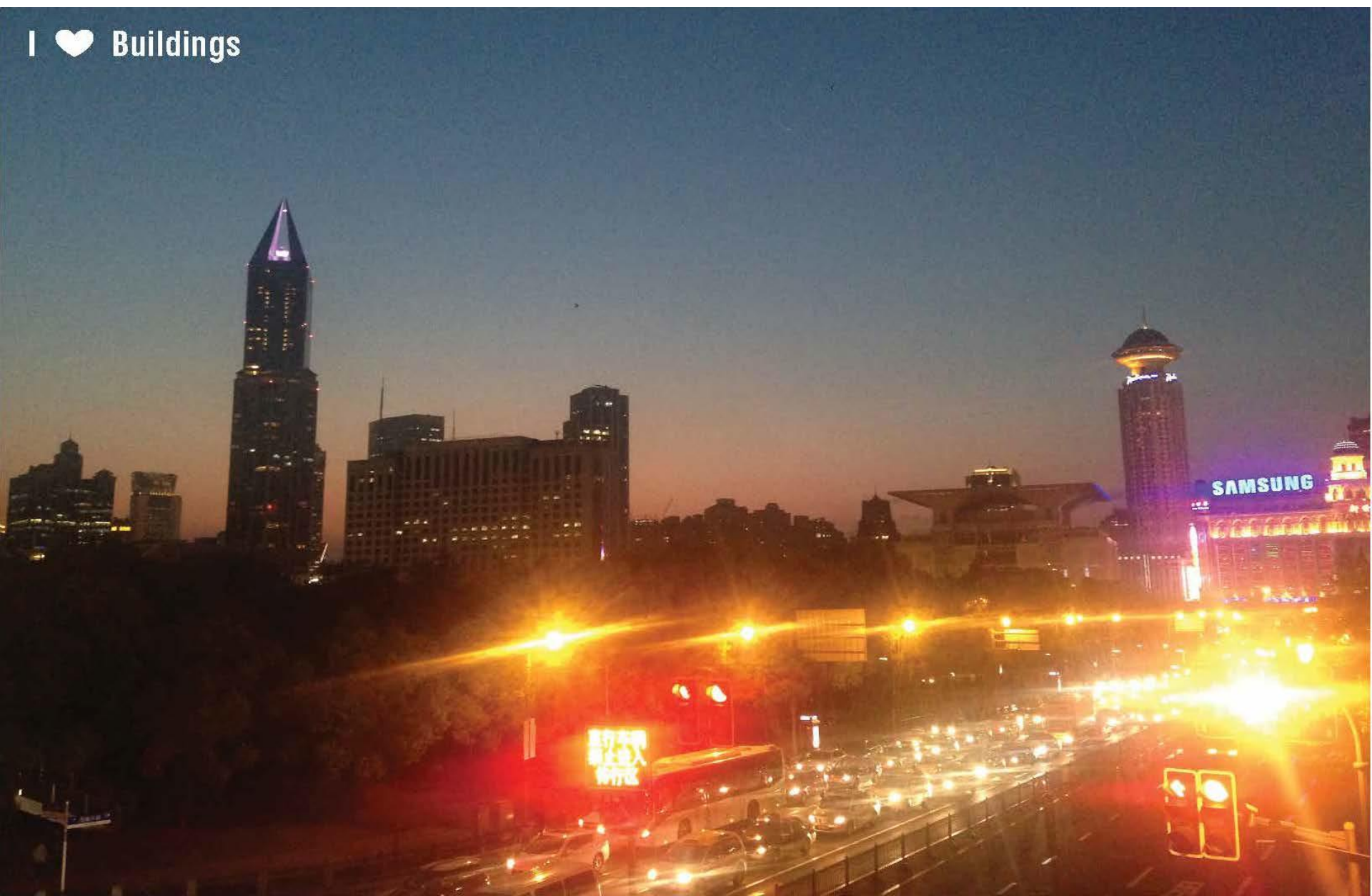

Inversive Adjacencies

a hotel of unintended destinations

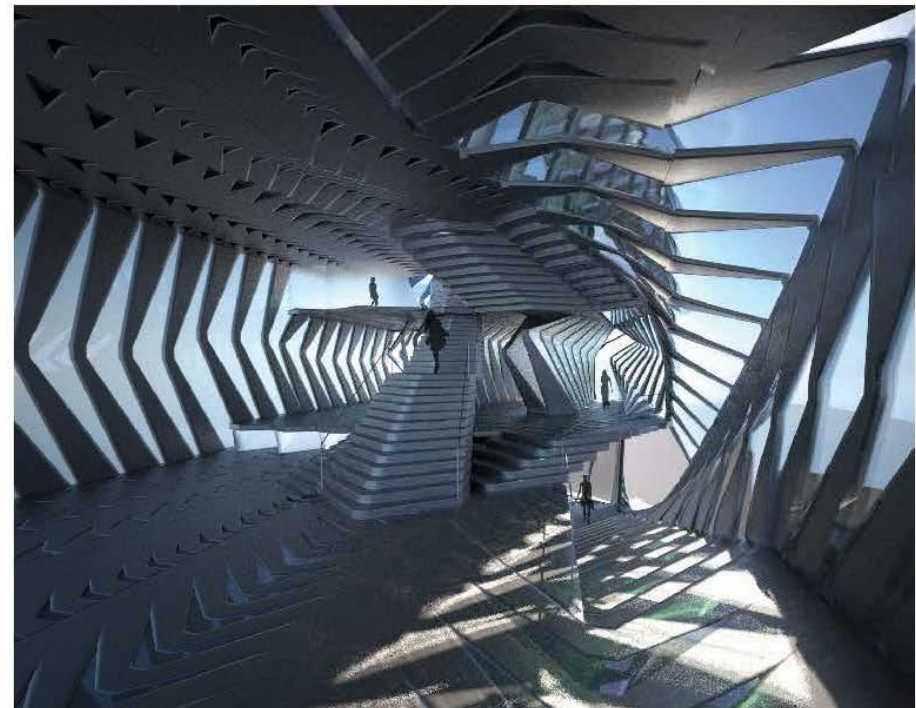
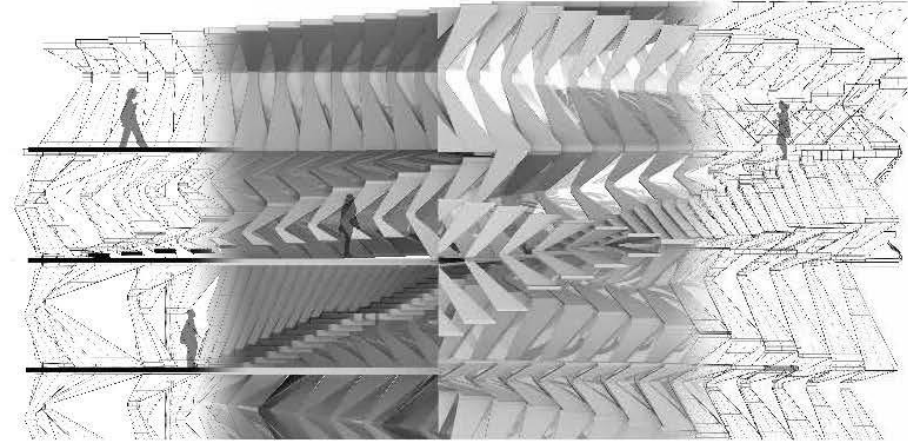
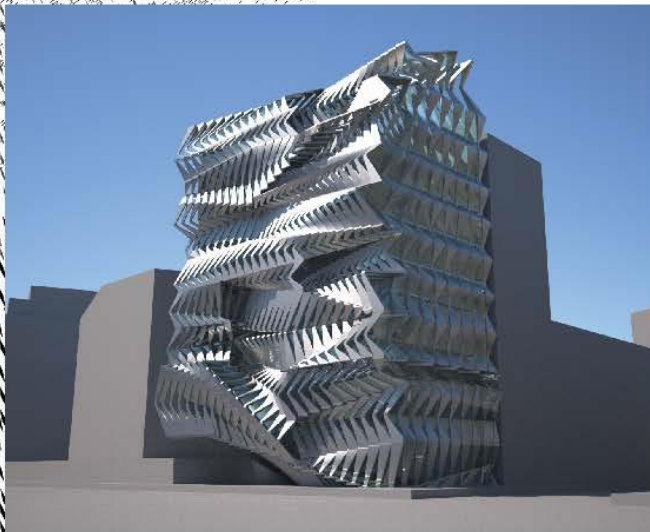

Transformative Structure

a theatre for seeing and being seen

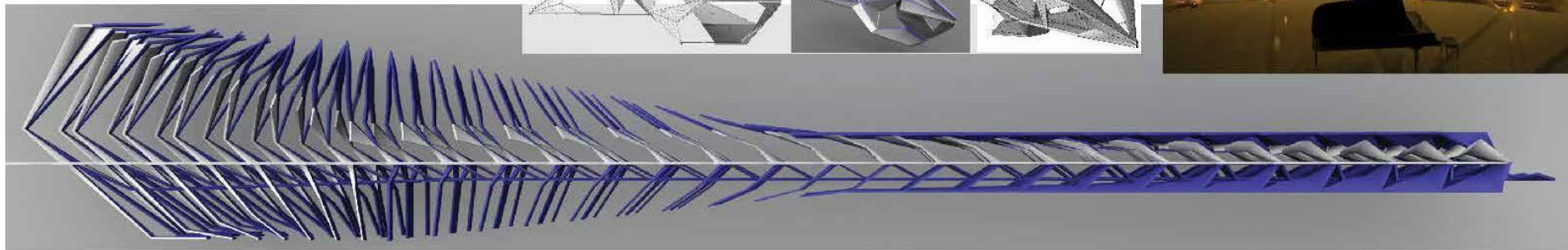
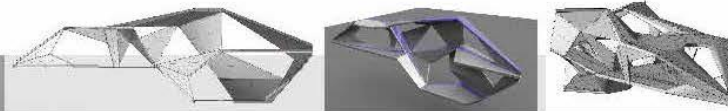
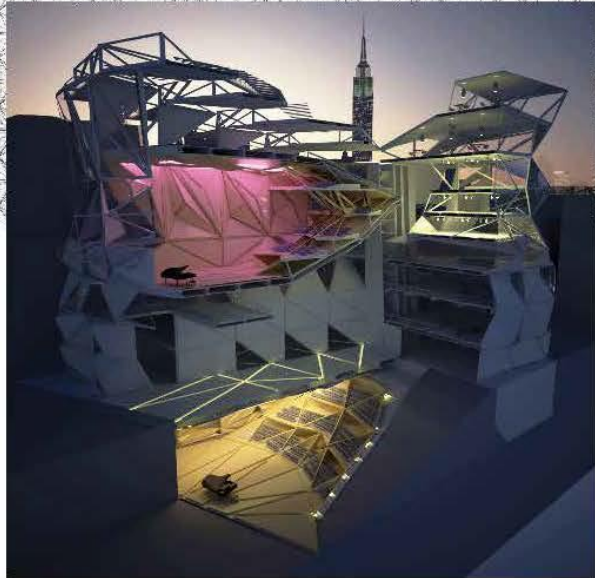

Nanjing International Youth Cultural Centre



Zaha Hadid
Nanjing, China



Dalian International Conference Center

*Coop Himme(l)blau
Dalian, China*

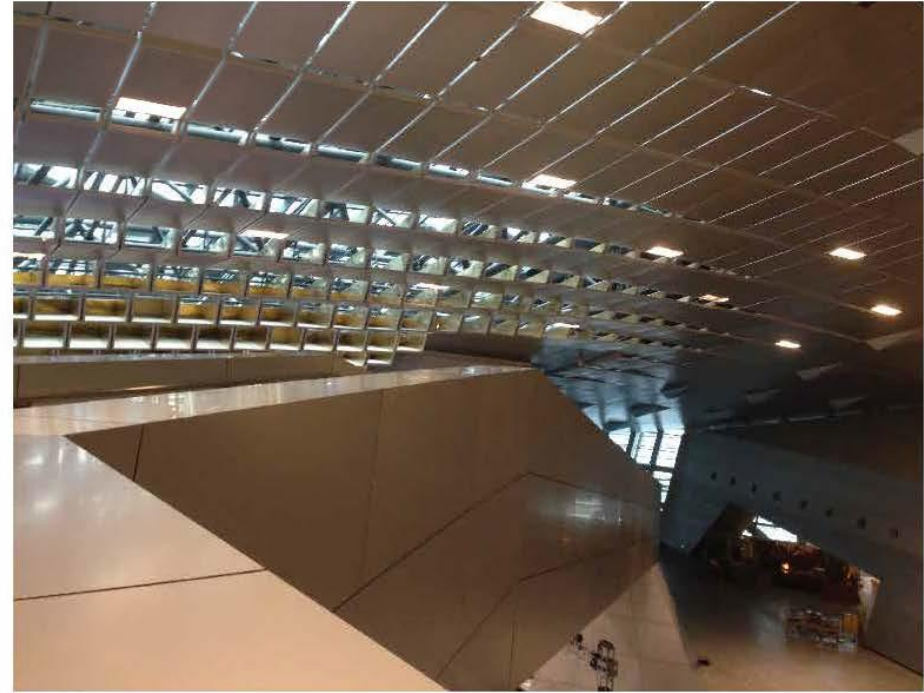
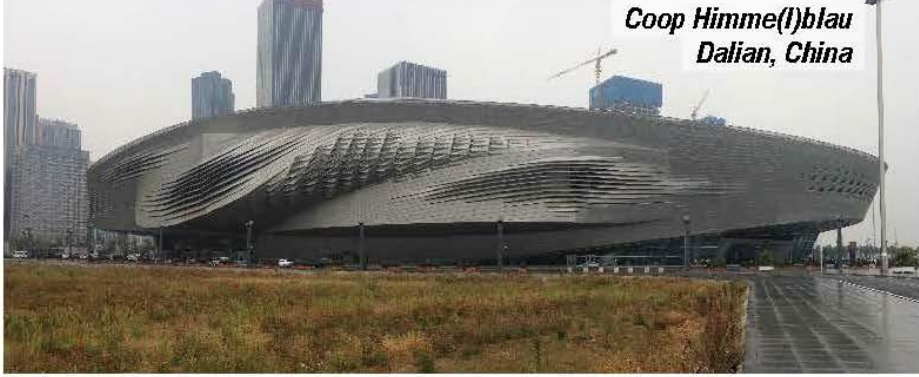

Tectonics of Economics

a bridge between culture and commerce

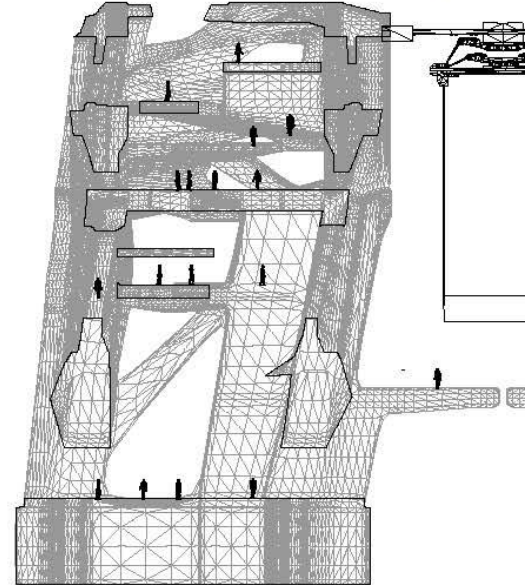
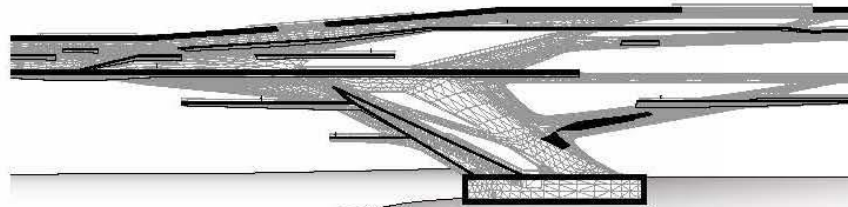
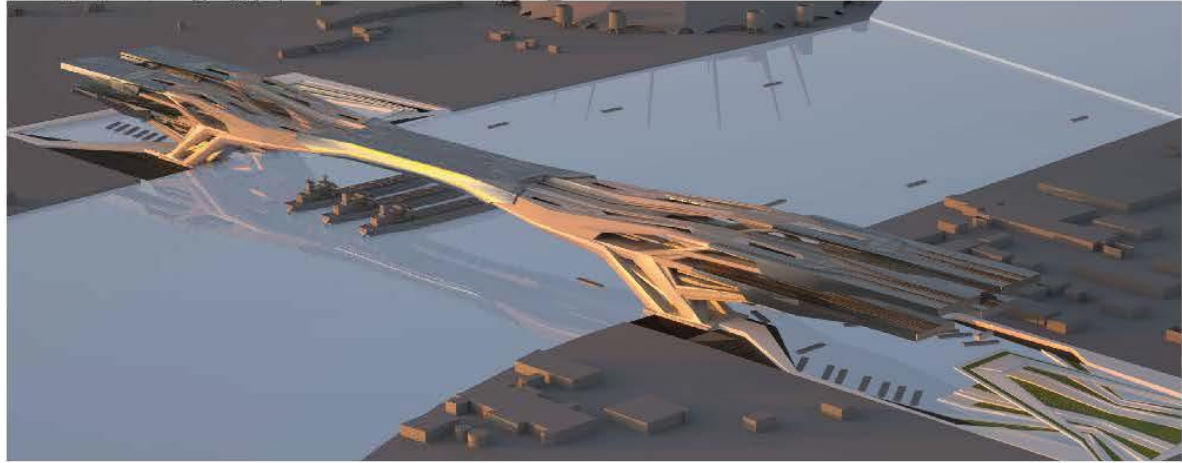
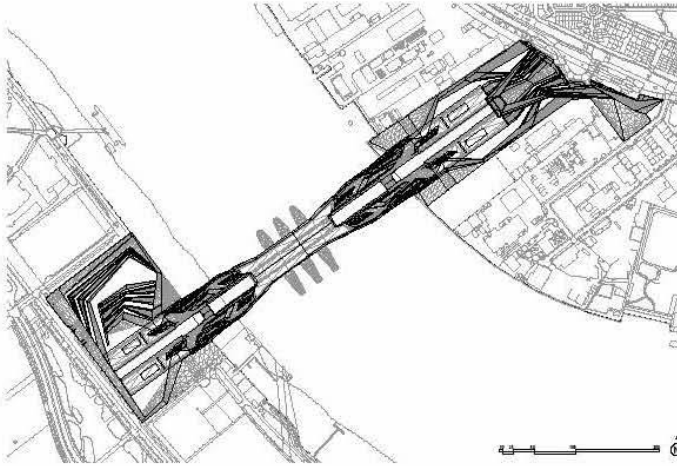

Central St. Giles

*Renzo Piano
London, England*



Ecology in the Sky

MAD

Kuala Lumpur, Malaysia

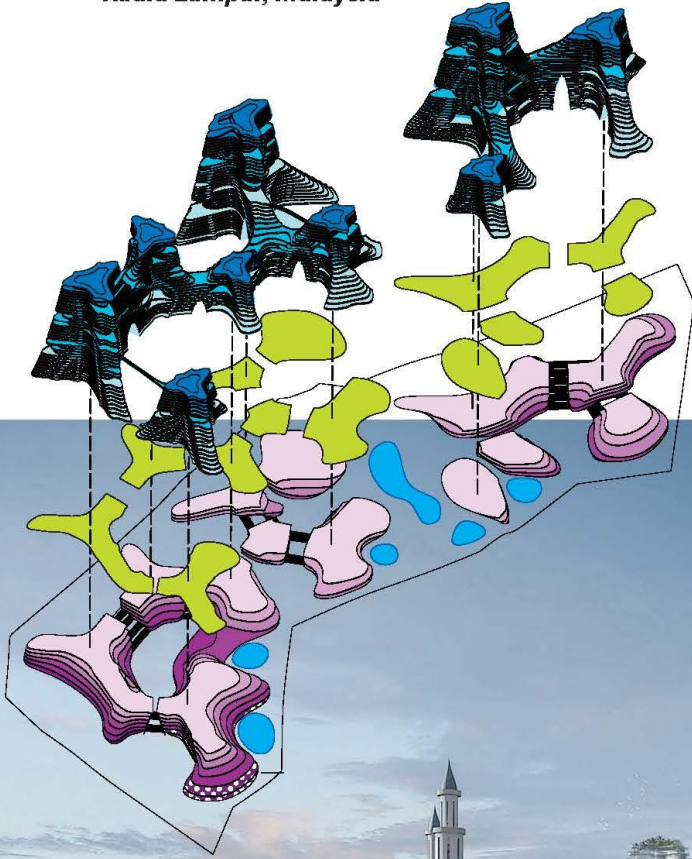

Water, Stone, Void

MAD
Beijing, China

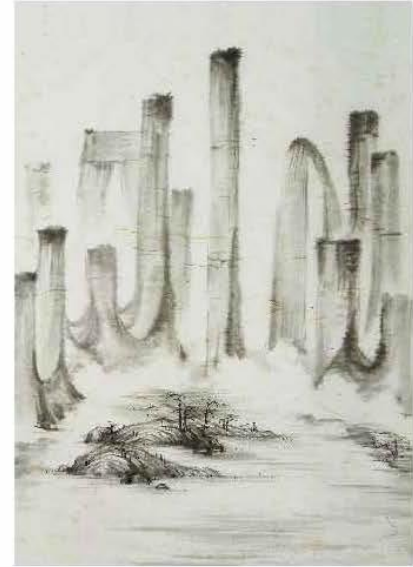

Gemdale Shopping Mall

Callison
Shenzhen, China

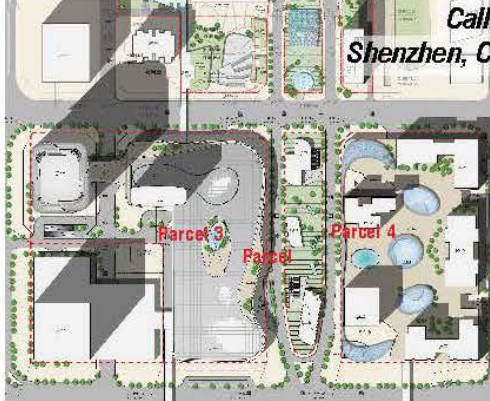

The Joy of Towers

*Goettsch Partners
various locations, China*



Qi Qi Guai Guai

various locations, China

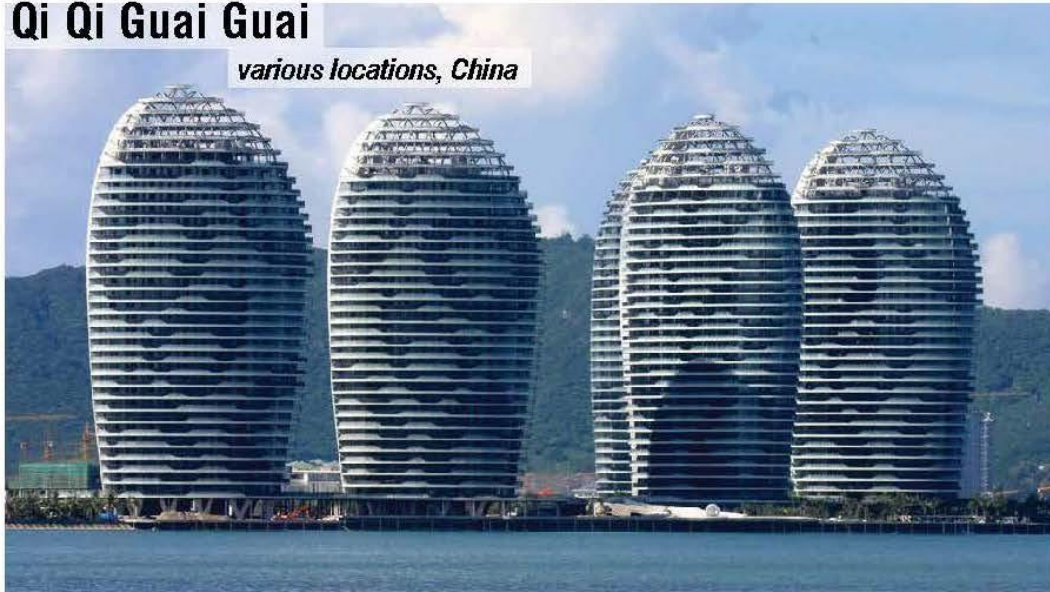

Jin Mao Tower

*Skidmore Owings and Merrill
Shanghai, China*

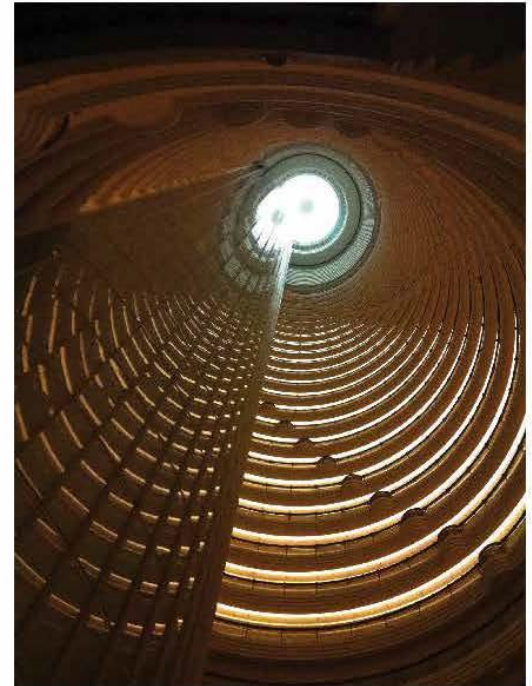

Anhui, China

ancient materials, innovative construction

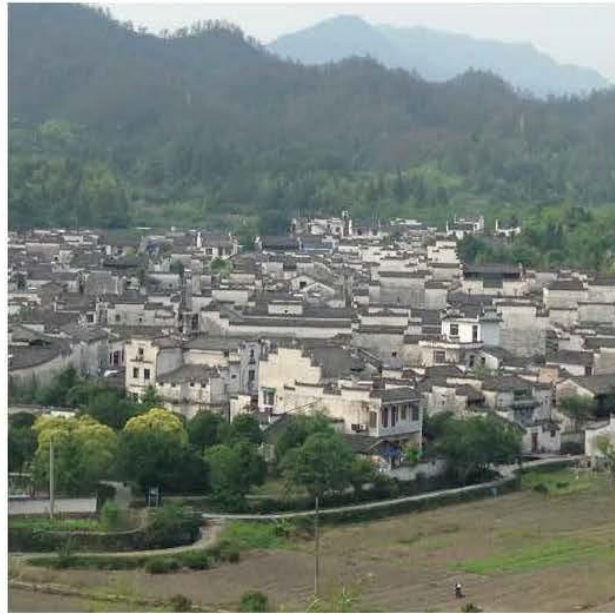

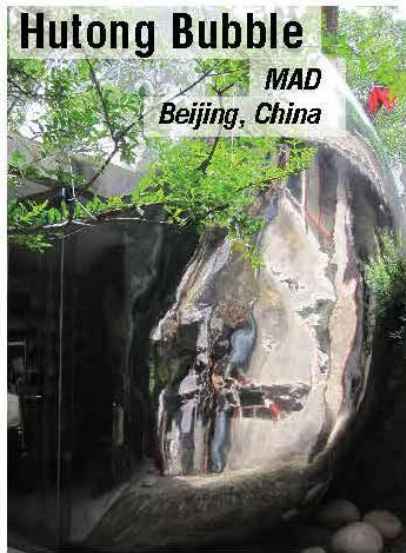

Yokohama Terminal

*Foreign Office Architects
Yokohama, Japan*



Salk Institute

Louis Kahn
La Jolla, California

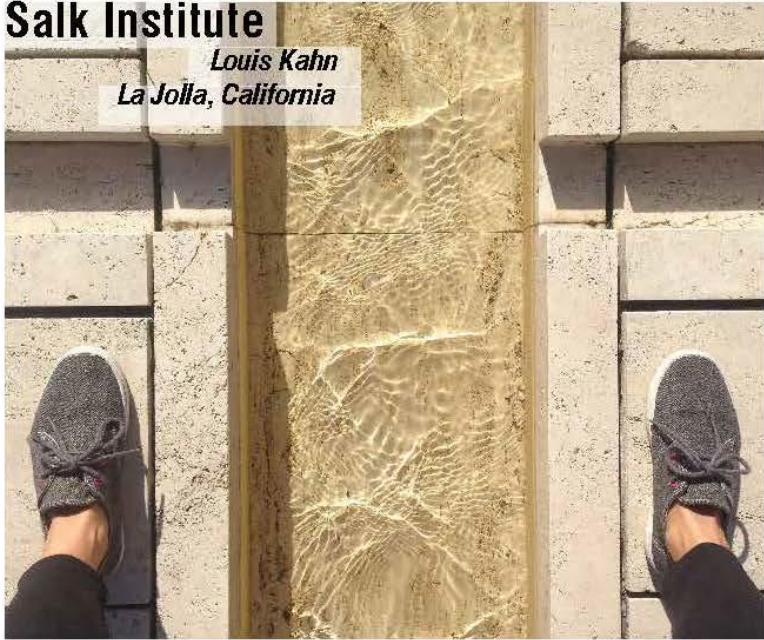

Chinese doors

*creatives of yesterday, today, and tomorrow
various locations, China*

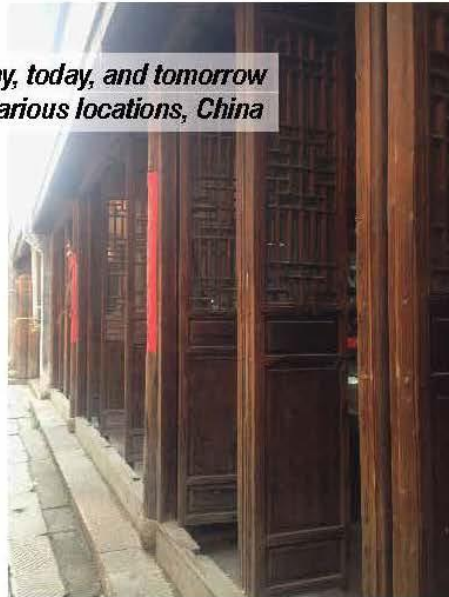

LaLuce Mitchell

EQUILIBRIUM









Out of
EQUILIBRIUM





...

@chi_geek

[Follow](#)

Demolition permit issued today for last worker's cottage in Gold Coast, built in 1872. Green fencing is up and it's ready to go. 🏠🏠

1:13 PM - 28 Oct 2016



23



14









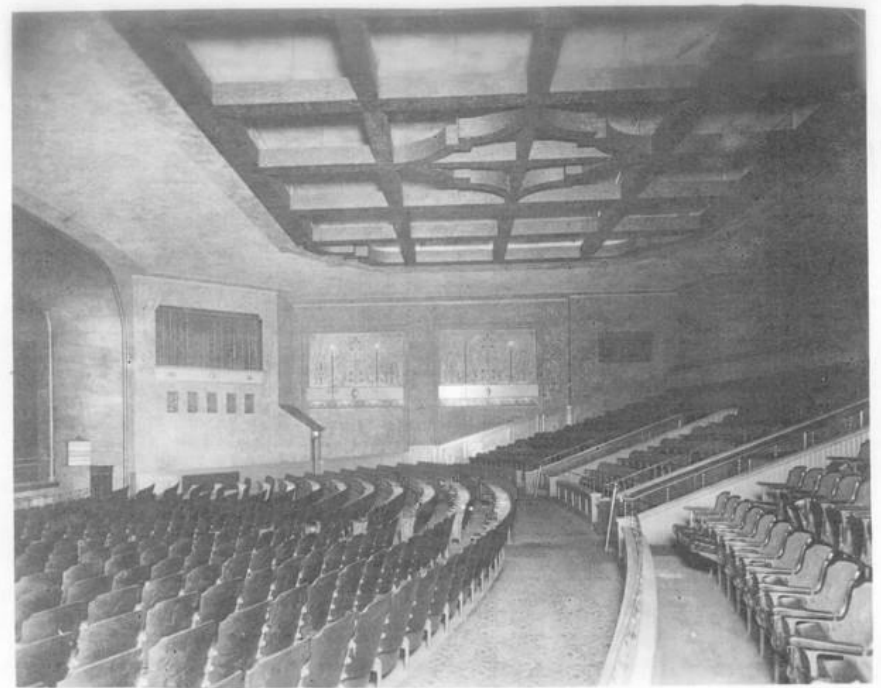

Cinematreaures.com



Bdtonline.com











Buffalorising.com



Buffalorising.com



Buffalorising.com

Jenifer Kaminsky



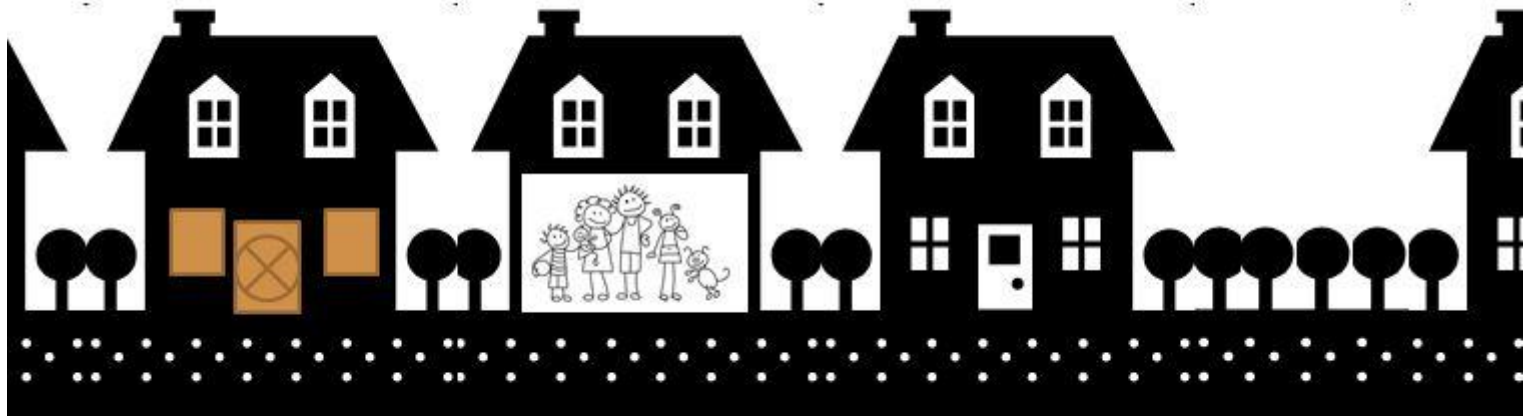

Proportion of households spending less than 30% of their income on housing costs

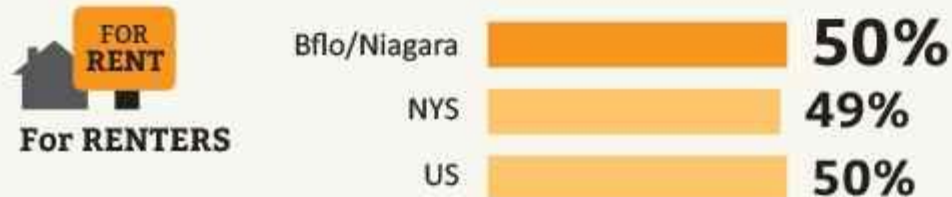
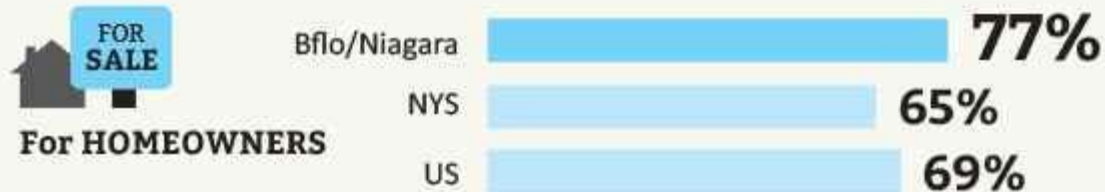

Source: Social Explorer Tables: ACS 2010 (1-Year Estimates) (SE), ACS 2010 (1-Year Estimates), Social Explorer; U.S. Census Bureau.

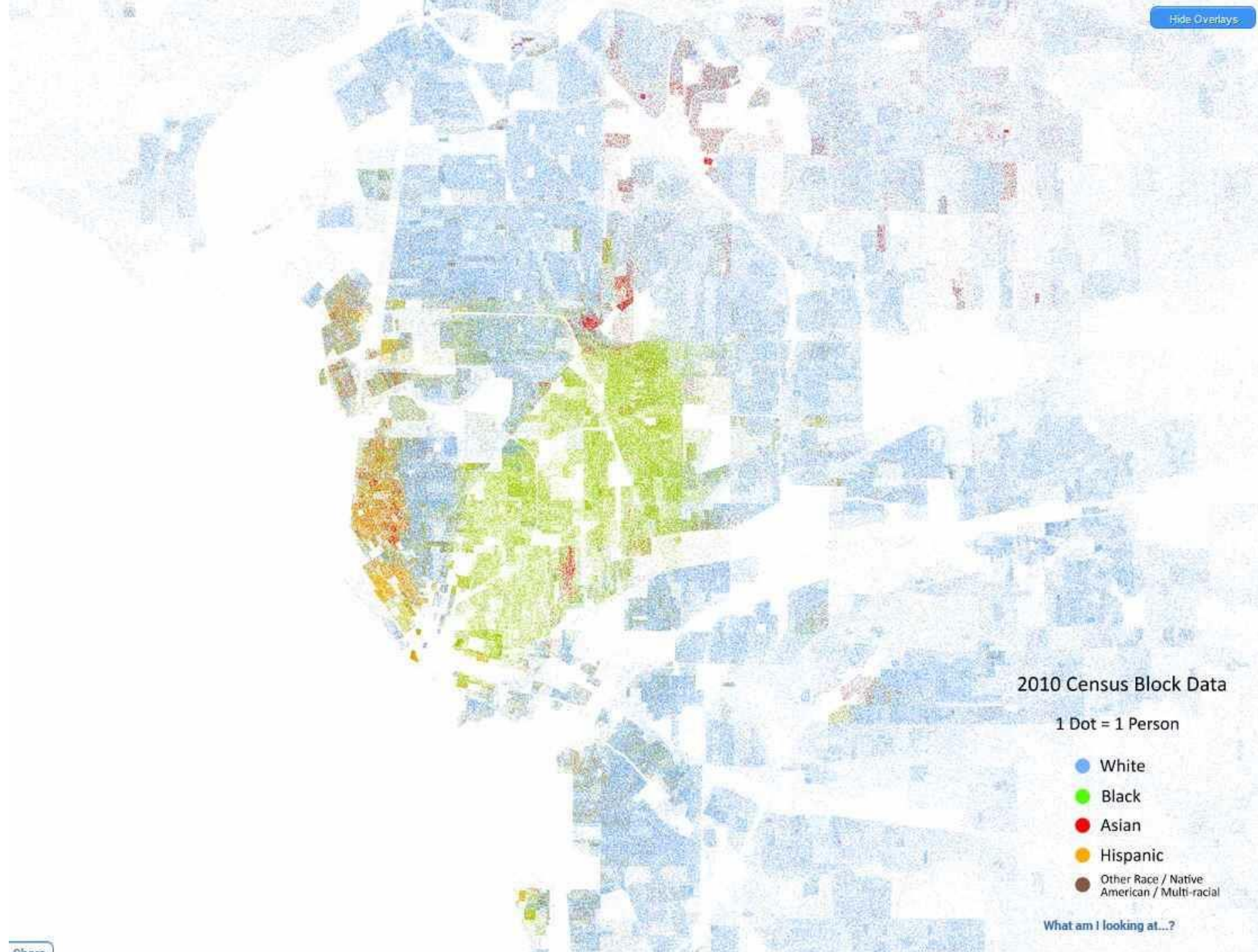

PROJECT MAP



















BNSC/PUSH
TRAINING HOUSE

THANK YOU
TO ALL SPONSORS



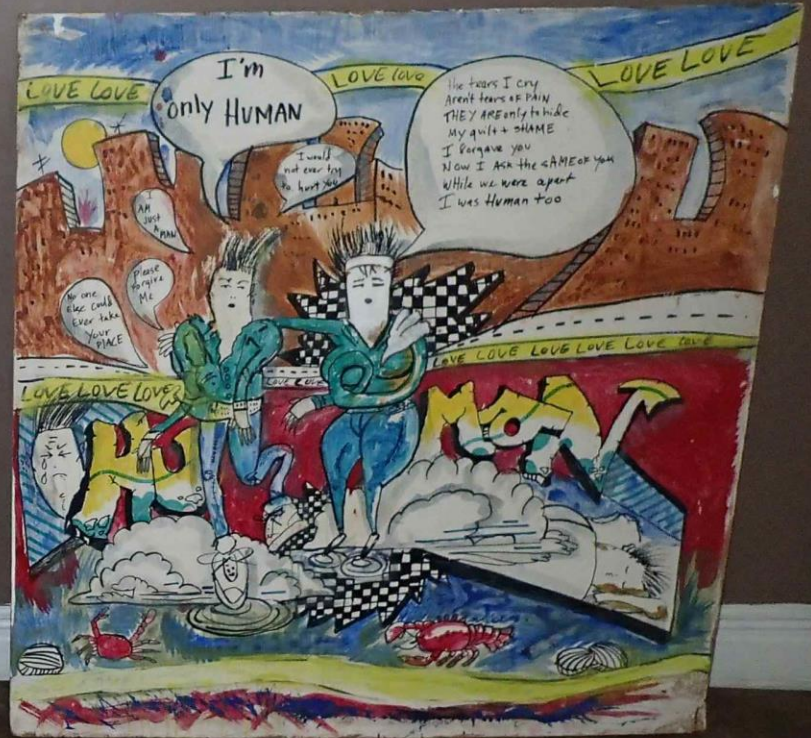







Residents' Community Lounge next to Entrance Lobby with Kitchenette

Michael Hungerford

Mike Hungerford

Management Consulting -> Lawyer -> Founder

Advisor to investors; tech co's

Moved away, came back

FoundFuture

Help high school and college students **make better decisions about the future.**

Record conversations with working professionals.

Available on the internet.

foundfuture.org



@found.future

FOUND**FUTURE**

Why?

Ill equipped to make a decision.



Bad advice.



Little emphasis.

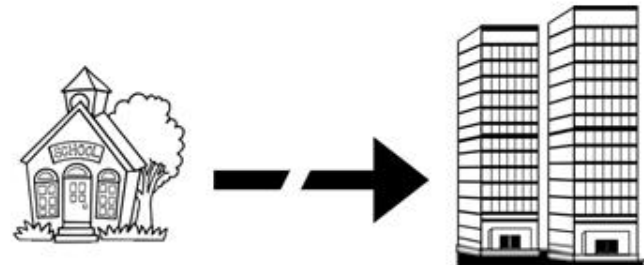

????????????????????



What's out there?

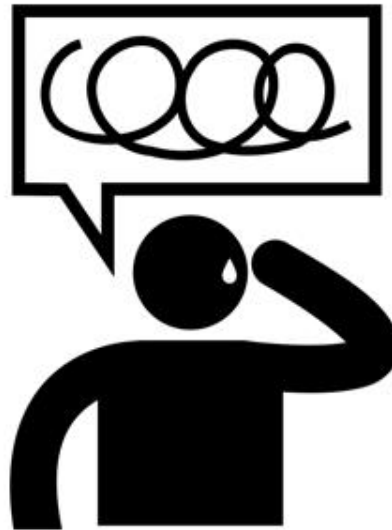

Who am I?



The unknowable.

Confusing, Harmful Advice



Follow your **passion!**

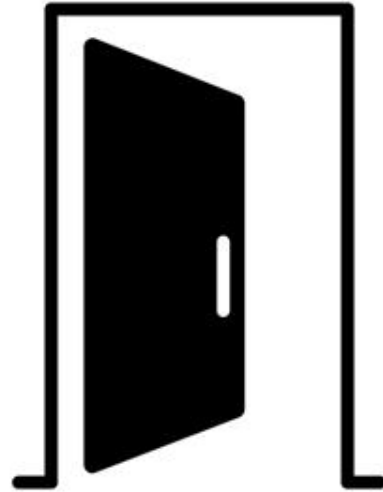

Keep your **options**
open.

Missing Emphasis

Parents and schools focus on academic maturity.

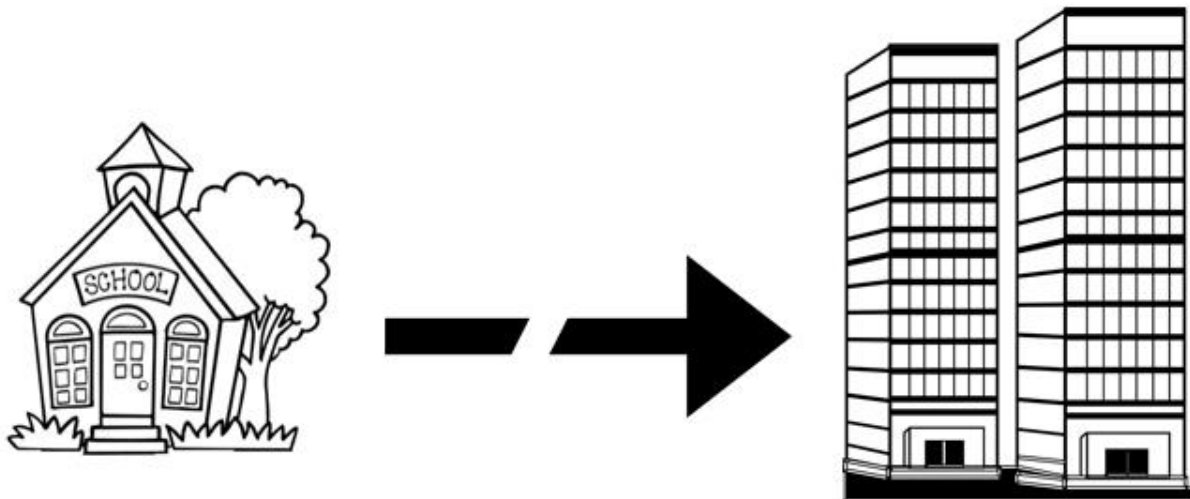

Career maturity is an afterthought at best.

Career Maturity

Career maturity is better predictor of success than SAT scores or high school GPA.

A+



Knowing why matters.

Career maturity helps put school in a **larger context.**

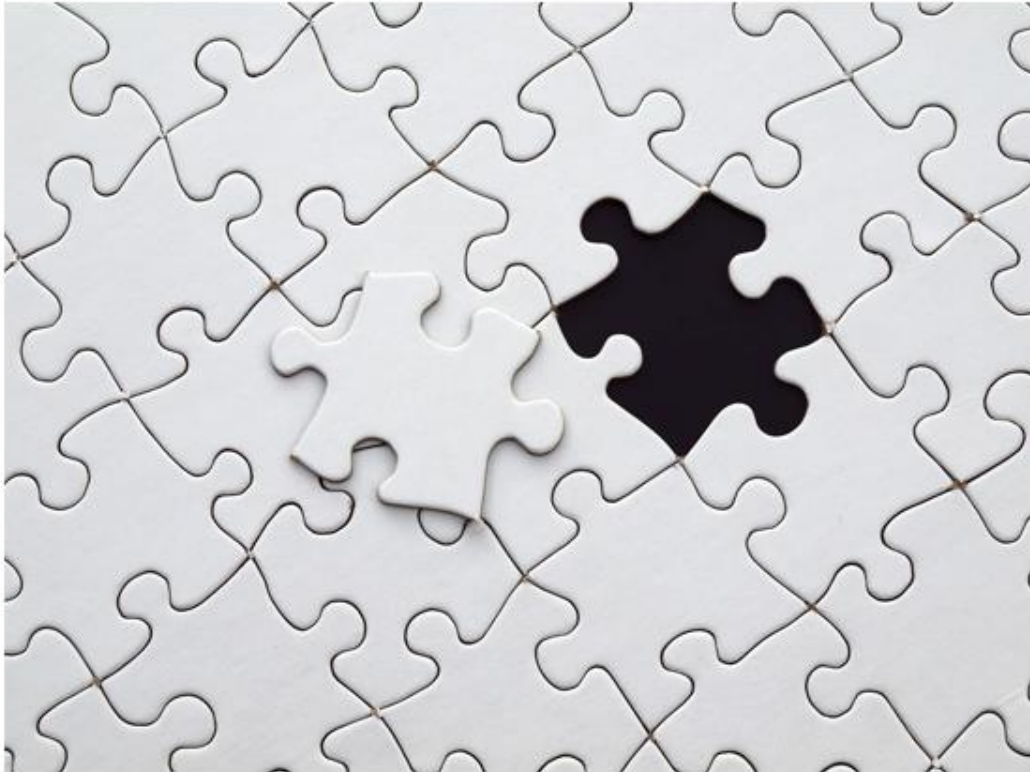

Our approach.

Develop career maturity by helping:

Discover random jobs and careers

Access in-depth information

Figure out **how to break into** a field

Major Key Alert - Engagement is essential

Honest, Unfiltered

Students aren't stupid.

16-22 year olds aren't children.

An honest, respectful tone is essential to building trust.

If you hold back students stop listening

Human Connection



Additional Reference Points

Media over-emphasizes money and suffers from success bias.

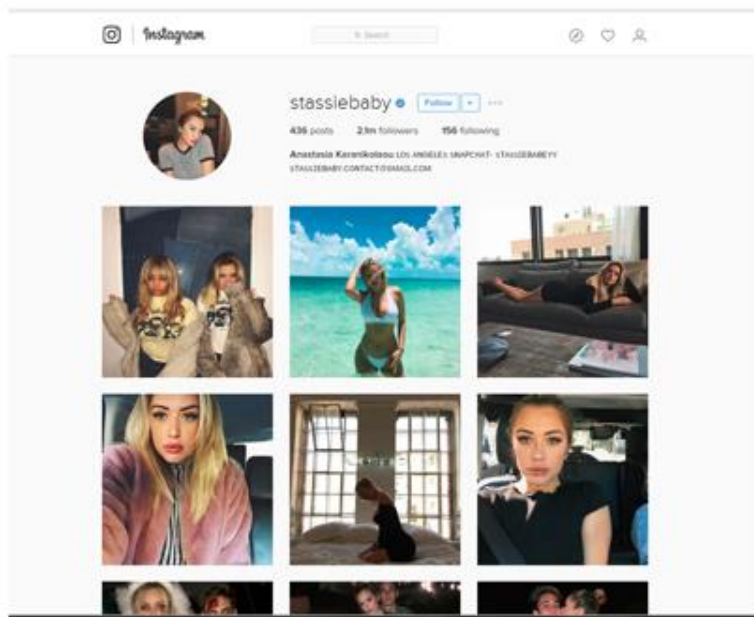

Conversations

**Conversations run about 90 minutes total.
Sixty minutes of talking and 30 minutes of getting
settled in and then packing up.**

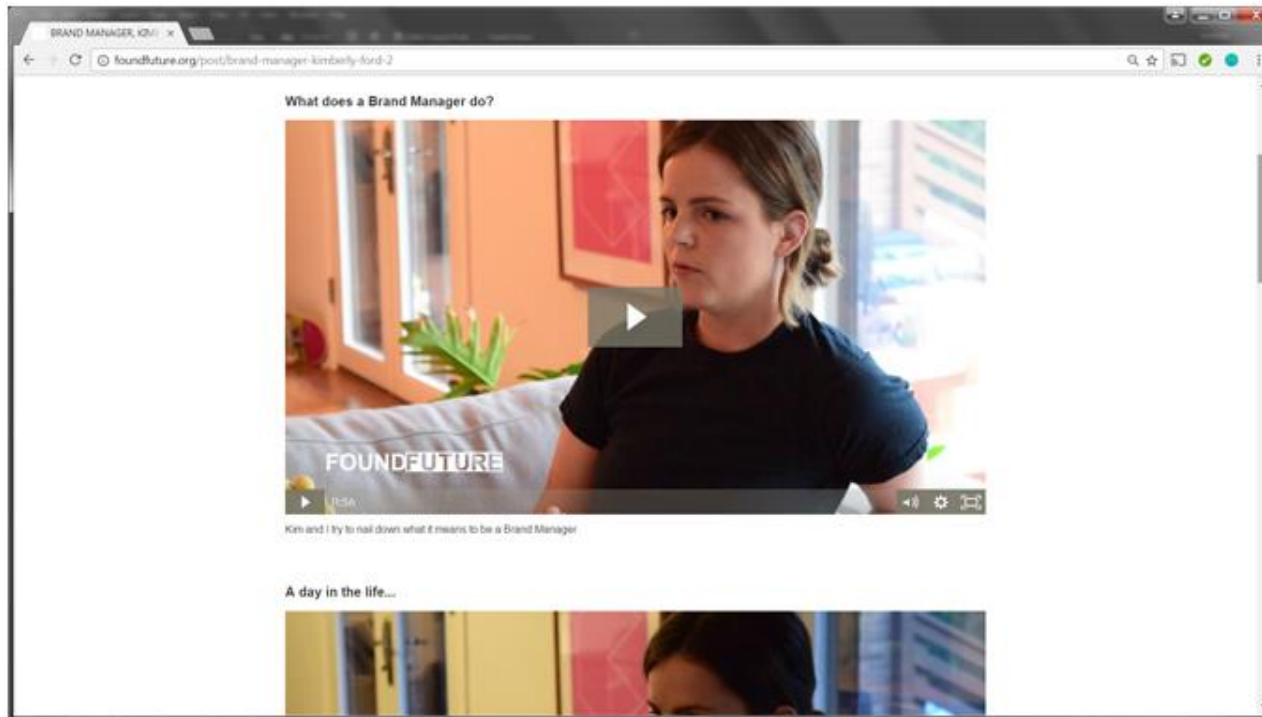

Recording Setup

Not ideal.

Three Nikon D3300's



Zoom H5 Recorder



Adobe Premiere Pro CC



Online Video

Each conversation ends up around 60 minutes.

Split into 4-6, smaller, digestable sections.

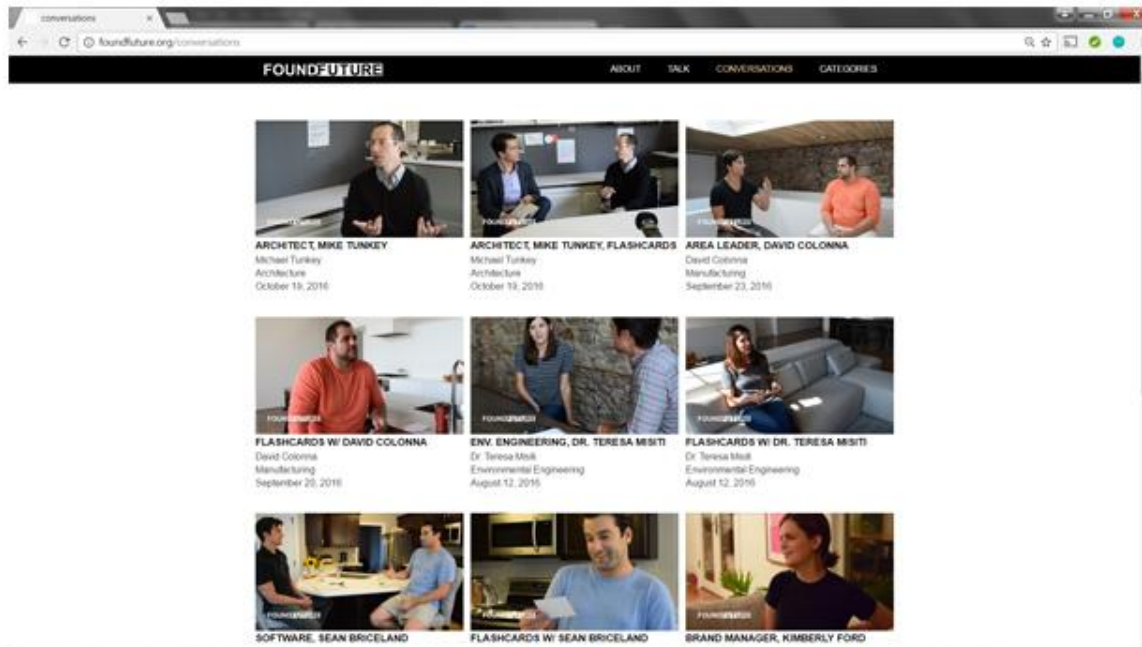

Online Courses

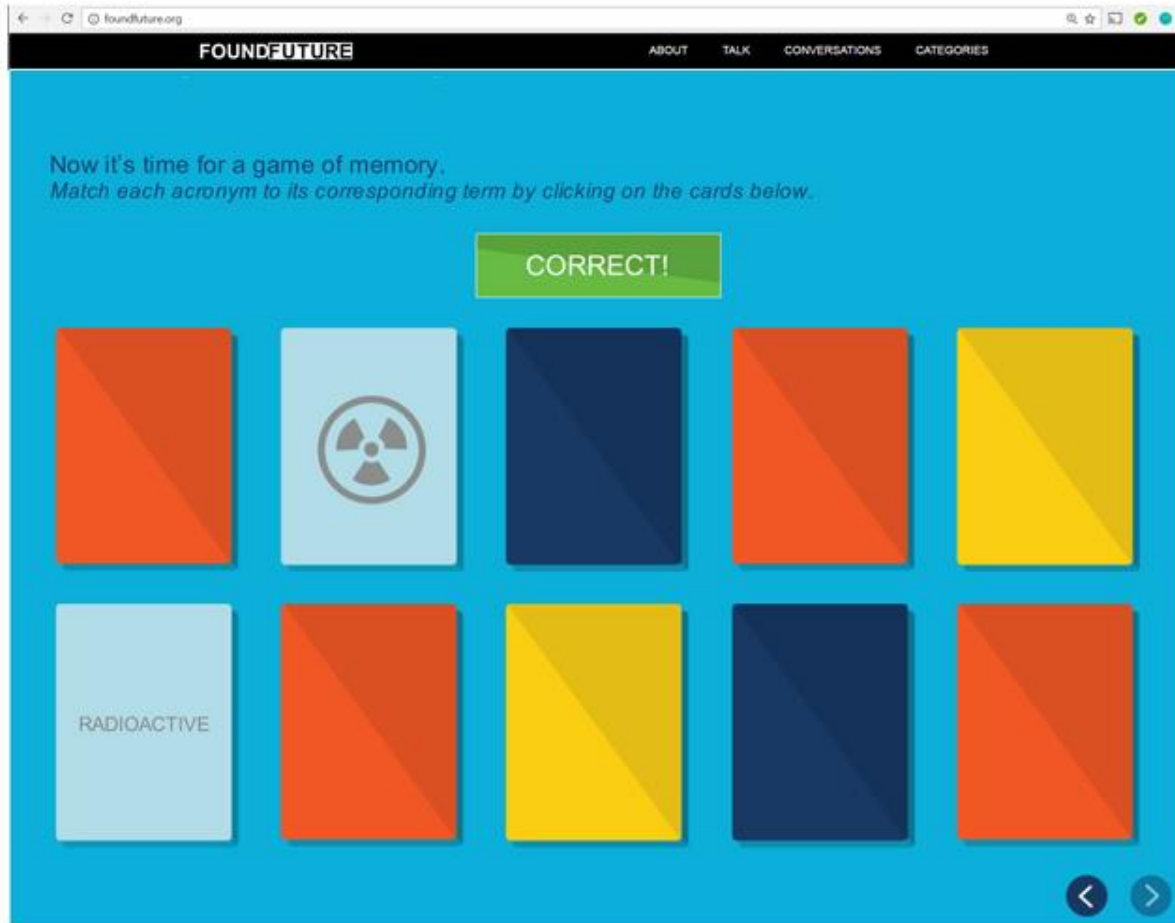

In January, courses on finding career direction, picking colleges, getting more out of college, and more will be available on foundfuture.org.

Let's Talk

Your story can help.

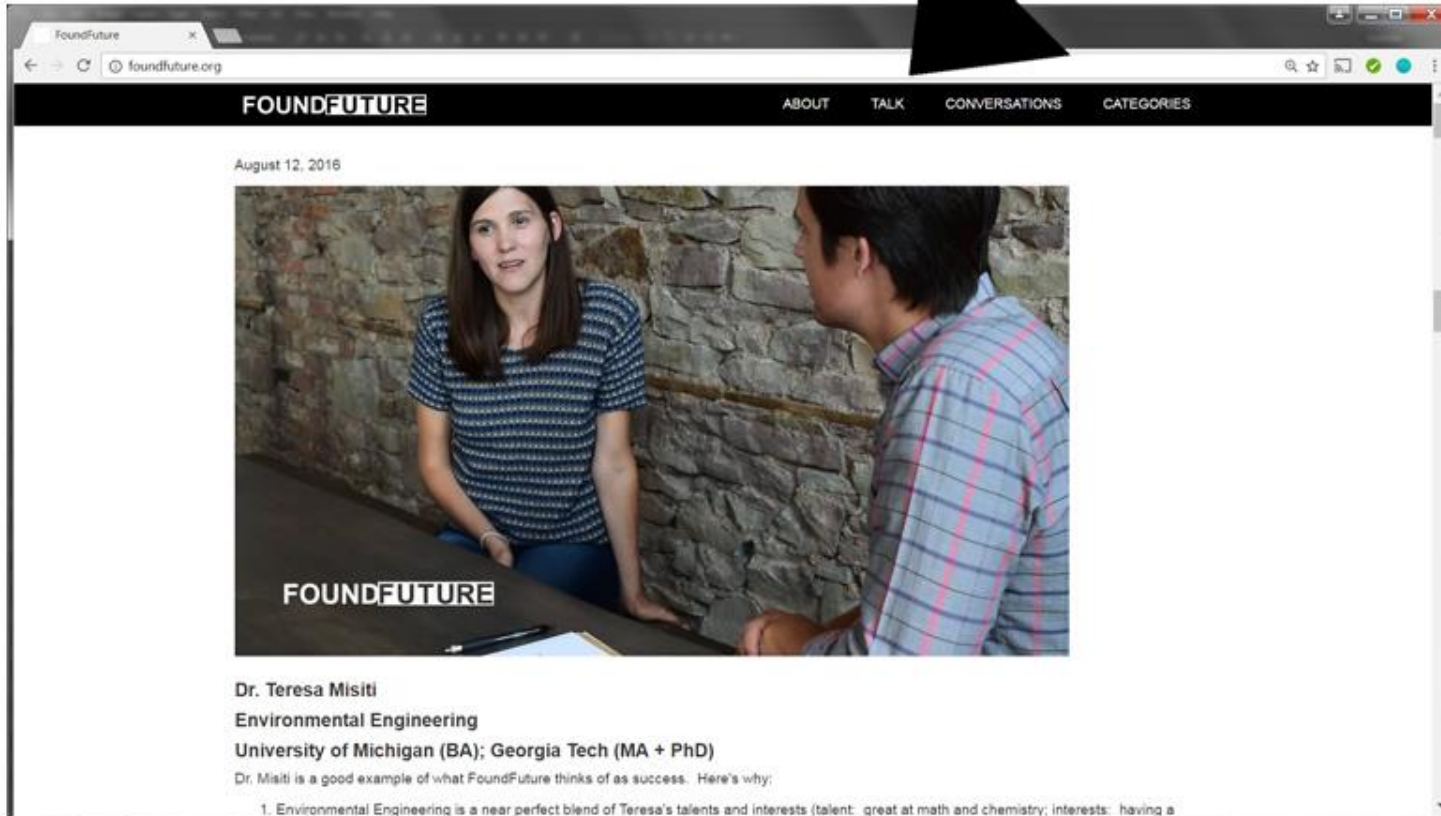
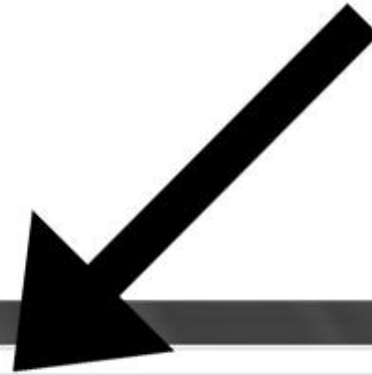

FOUND**FUTURE**